

2. CUTTING-, STRIPPING AND CRIMPING TOOLS

2.5 Power-assisted compression tools with exchangeable die-sets

Additionally to the delivering of simply hand operated tools with a power gear ration generated by leverage forces, druseidt offers various kinds of power-assisted compression tools too. Such tools offer significant advantages, mainly when working under cramped conditions or serial production. In dependence of the frequency of use, the operating conditions and the design of the cable lugs, the user can select out of the following tools:

- Hand operated compression tools with ratchet**
 The press capacity and crimping depth of such tools are generated by a smooth-running and precise rotating eccentric construction. Where necessary the free movement is guaranteed through a construction with roller- and needle bearings. So the terminals can be crimped very easily by swinging the movable hand lever of the tools.
- Hand operated hydraulic compression tools**
 The crimping process can be activated by swinging the movable hand lever of the tools. The power gear ration will be realized by a single- or double piston pump.
- Battery operated electro-hydraulic compression tools**
 When working with such tools the power gear ratio will be realized by an electro-hydraulic aggregate. So a fatigue proof working is guaranteed. While working with batteries the tools are well suited for mobile application.
- Hydraulic working systems with exchangeable compression heads**
 Such systems consist out of a basic pump or electrohydraulic unit which can be equipped with exchangeable compression- or cutting heads. Caused by the deliverable different cutting- and compression heads the systems are suited for universal as well as mobile application.

In the range of hydraulic operated tools druseidt works as far as possible with exchangeable compression die-systems, that means that you can use the same dies inside of the hand- as well as battery- or electro-hydraulic operated tools.

druseidt-system dies

applicable inside of hand- as well as battery- or electrohydraulic operated tools

System dies size I

druseidt flat dies



System dies size II

druseidt half shell dies in small design



System dies Size III

druseidt half shell dies in large design



Mechanical crimping tool
with ratchet and revolving dies 6-35 mm²
for cable lugs acc. to DIN 46234



die set and crimping form

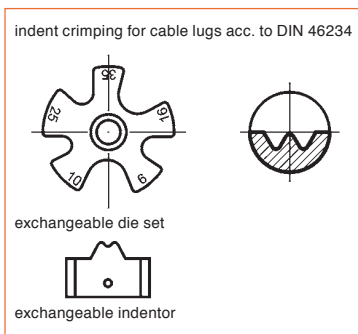

Part-No.	cross-section range	crimping force	description	length	weight kg/pcs.
12650	6 - 35 mm ²	ca. 28 kN	crimping tool with revolving dies	310 mm	1,30
12651	steel carrying case				

Remark: Mechanical crimping tool with ratchet suitable for one hand operation. Cable lugs can be crimped very easily by swinging the moveable hand lever. Only one die set is required by crimping cable lugs in a cross-section range 6-35 mm². The construction with the built-in-force-blocking device guaranteed a constant and exact crimping-depth and therefore an excellent electrical and mechanical quality of the crimping connection. The handy design and the collapsible tool head offers also a working in cramped conditions.

Mechanical crimping tool

with ratchet and exchangeable die sets 6-50 mm²

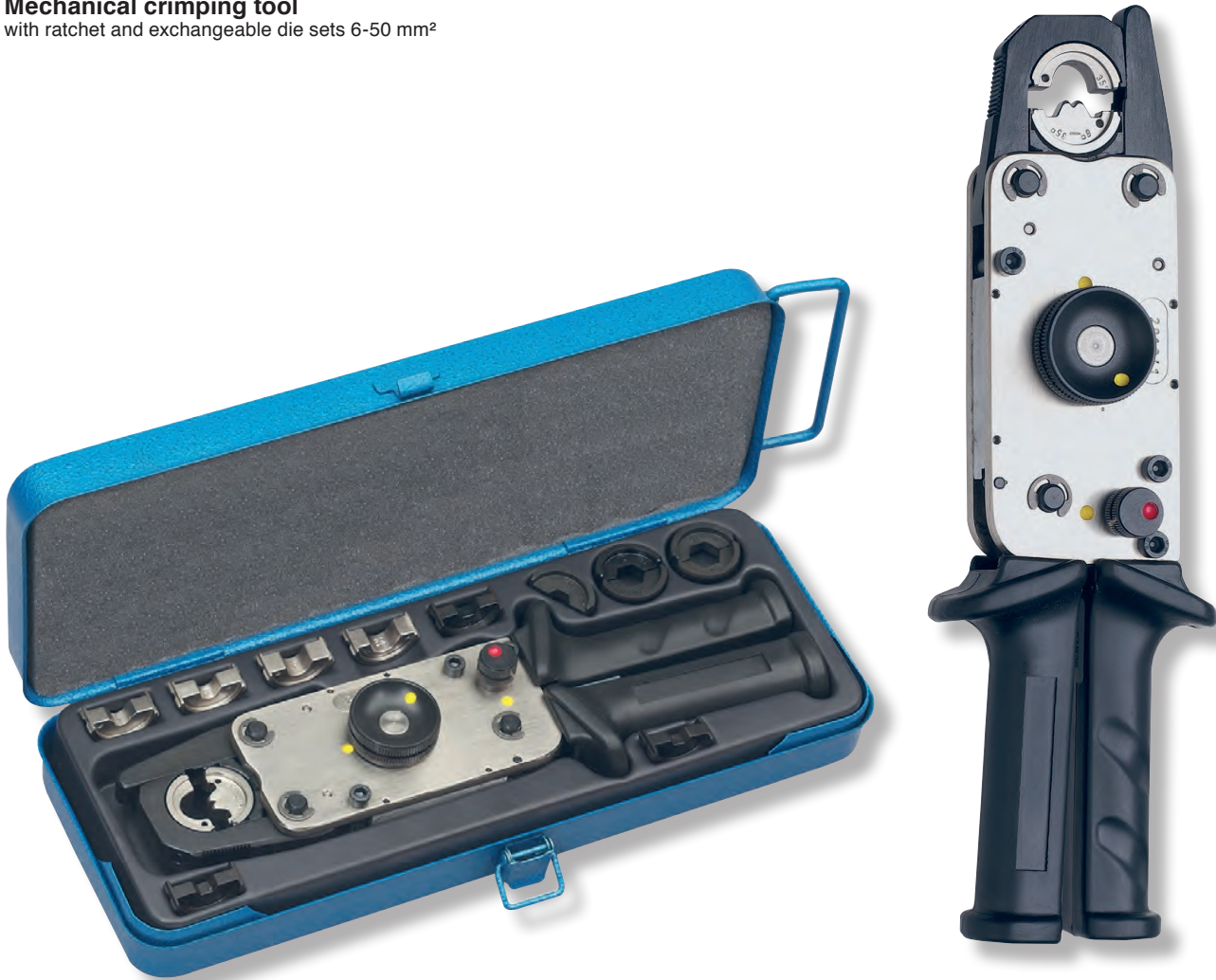

Part-No.	cross-section range	crimping force	description	length	weight kg/pcs.
12655	6 - 50 mm ²	ca. 28 kN	crimping tool without die sets	280 mm	1,20
12656	steel carrying case				

Remark: Mechanical crimping tool with ratchet for one hand operation Terminals can be crimped very easily by swinging the moveable handle. The construction with the built-in-force-blocking device guaranteed a constant and exact crimping-depth and therefore an excellent electrical and mechanical quality of the crimping connection. The handy design and the collapsible tool head offer also a working in cramped conditions. Exchangeable die sets with different crimping profiles offer an effective working inside of different kinds of applications. The handy design combined with the solid steel carrying case make the tool particularly well suited for working on installations out of your factory.

Deliverable die sets

Indent crimping 6-35 mm²

for cable lugs acc. to DIN 46234

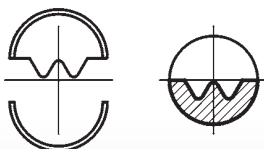

Part-No.	cross-section mm ²	Part-No.	cross-section mm ²
12657	6	12660	25
12658	10	12661	35
12659	16	12662	indentor 6 - 35 mm ²

Remark: When placing an order about dies 12657-61 it is necessary to order the indentor 12662

WM-crimping 6-50 mm²

for tubular cable lugs
in druseidt standard design

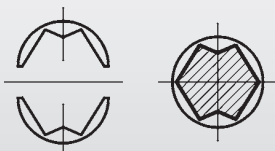

Part-No.	cross-section mm ²	crimping width mm
12665	6	6
12666	10	6
12667	16	6
12668	25	6
12669	35	6
12670	50	6

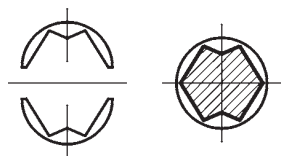
Exchangeable die sets for crimping tool Part-No. 12655**WM-crimping 6-50 mm²**for tubular cable lugs
druseidt Euro-type design

Part-No.	cross-section mm ²	crimping width mm
12468	6	5
12469	10	5
12470	16	5
12471	25	5
12472	35	5
12473	50	5

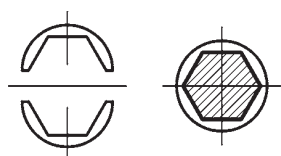
Hexagonal-crimping 6-50 mm²for copper cable lugs and connectors
acc. to DIN 46235/46267 part 1

Part-No.	cross-section mm ²	code-no.	crimping width mm
12671	6	5	5
12672	10	6	5
12673	16	8	5
12674	25	10	5
12675	35	12	5
12676	50	14	5

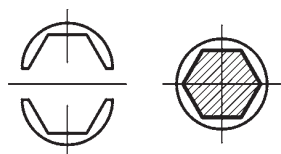
Hexagonal-crimping 6-50 mm²for aluminium cable lugs and connectors
acc. to DIN 46329/46267 part 2

Part-No.	cross-section mm ²	code-no.	crimping width mm
12456	16/25	12 Al	7
12457	35	14 Al	7
12458	50	16 Al	7

Trapezoid-crimping 6-50 mm²

for cable end sleeves acc. to DIN 46228 page 1 + 4

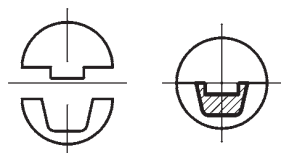

Part-No.	cross-section mm ²	crimping width mm
12652	6	18
12653	10	18
12654	16	18
12677	25	18
12678	35	18
12679	50	18

Oval-crimping 10-25 mm²

for insulated cable lugs

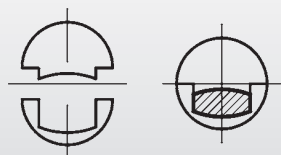

Part-No.	cross-section mm ²	information
12460	10	suitable for cable lugs
12461	16	acc.to catalogue pages 15 + 16
12462	25	

Mechanical crimping tool

with ratchet and exchangeable die sets 6-120 mm²



Part-No.	cross-section range	crimping force	description	length	weight kg/pcs.
30460	6 - 120 mm ²	ca. 55 kN	crimping tool without die sets	430 mm	2,00
30470	steel carrying case				

Remark: Handy mechanical crimping tool with ratchet. Terminals can be crimped very easily by swinging the movable handle. The construction with the built-in-force-blocking device guaranteed a constant and exact crimping-depth and therefore an excellent electrical and mechanical quality of the crimping connection. The collapsible tool head enables a quick changing of the die sets. The handy design and the little weight offer also a working in cramped conditions.

Deliverable die sets

Indent crimping dies 6-70 mm²

for cable lugs acc. to DIN 46234

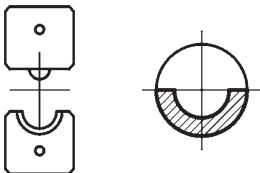

Part-No.	cross-section mm ²	Part-No.	cross-section mm ²
12680	10 + 16 + 25 + 35	12683	Indentor 6 - 70
12681	6 + 50		
12682	70		

Information: When placing an order about dies 12680-82 it is necessary to order the indentor 12683 too.

WM-crimping 10-120 mm²

for tubular cable lugs
druseidt standard design

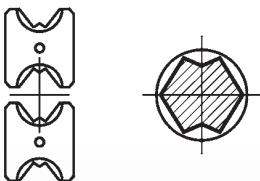

Part-No.	cross-section mm ²	crimping width mm
12685	10 + 70	7
12686	16 + 35	7
12687	25 + 50	7
12688	95	5,5
12689	120	5,5

WM-crimping 10-120 mm²

for tubular cable lugs
druseidt Euro-type design

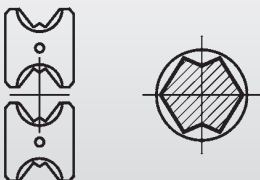

Part-No.	cross-section mm ²	crimping width mm
12475	10 + 70	7
12476	16 + 35	7
12477	25 + 50	7
12478	95	5,5
12479	120	5,5

Exchangeable die sets for crimping tool Part-No. 30460

WM-crimping 10f-95f mm²

for tubular cable lugs
druseidt design for fine stranded cables

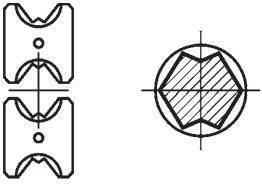

Part-No.	cross-section mm ²	crimping width mm
12515	10 f + 25 f	5
12516	16 f + 35 f	5
12517	50 f	5
12518	70 f	5
12519	95 f	5

Hexagonal-crimping 10-120 mm²

for copper cable lugs and connectors
acc. to DIN 46235/46267 part 1

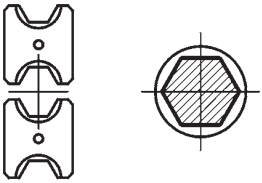

Part-No.	cross-section mm ²	code-no.	crimping width mm
12690	10 + 70	6 + 16	5,5
12691	16 + 35	8 + 12	5,5
12692	25 + 50	10 + 14	5,5
12693	95	18	5,5
12694	120	20	5,5

Hexagonal-crimping 16-95 mm²

for aluminium cable lugs and connectors
acc. to DIN 46329/46267 part 2

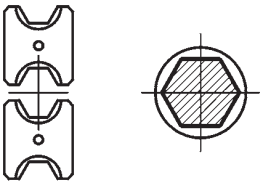

Part-No.	cross-section mm ²	code-no.	crimping width mm
12762	16/25 + 35	12 Al + 14 Al	7
12763	16/25 + 50	12 Al + 16 Al	7
12764	70	18 Al	7
12765	95	20 Al	7

Trapezoid-crimping 25-95 mm²

for cable end sleeves
acc. to DIN 46228 page 1 + 4

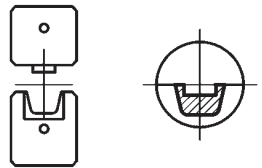

Part-No.	cross-section mm ²	pressing width mm	information
12390	25	26	When placing an order about dies 12390-94 it is necessary to order the suitable indenter.
12391	35	26	
12392	50	26	
12393	70	26	
12394	95	26	
Indenter			
12395	25 + 35	26	
12396	50 + 70	26	
12397	95	26	

Oval-crimping 10-35 mm²

for insulated cable lugs

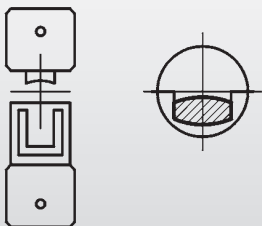

Part-No.	cross-section mm ²	information
12695	10	For use with cable lugs acc. catalogue pages 15 + 16.
12696	16	
12697	25	
12698	35	

Mechanical crimping tool

with ratchet
and exchangeable die sets 10-240 mm²

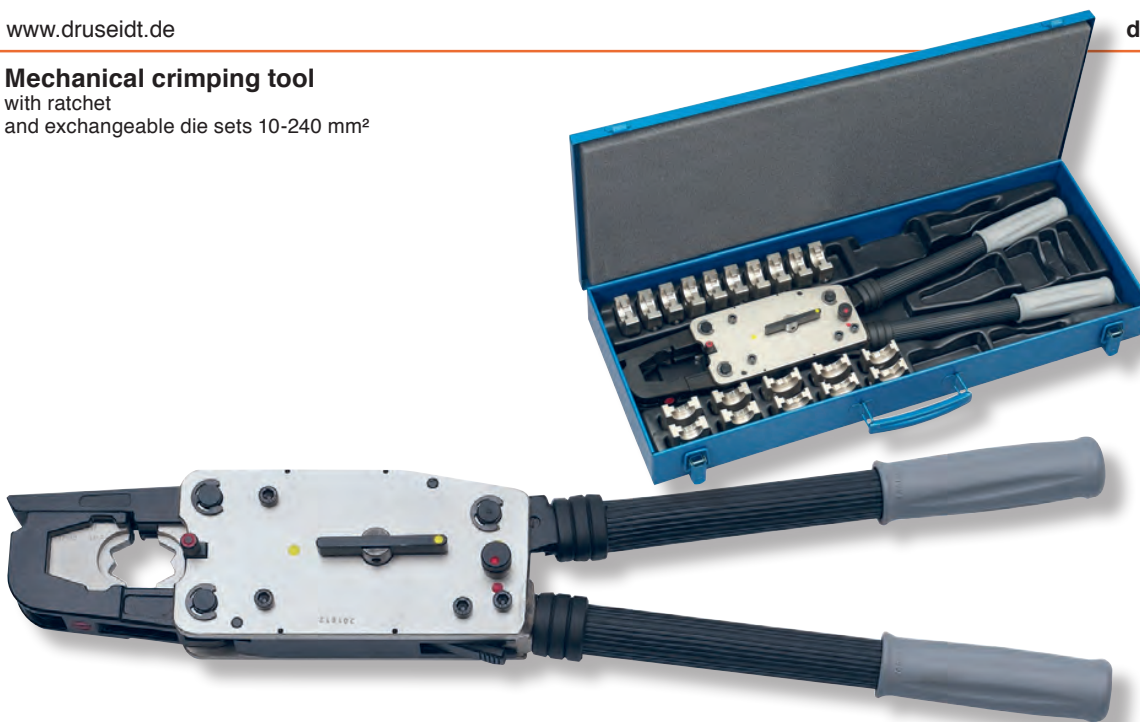

Part-No.	cross-section range	crimping force	description	length	weight kg/pcs.
31460	10 - 240 mm ²	ca. 100 kN	crimping tool without die sets	565 mm	4,00
31465	Steel carrying case				

Remark: Robust mechanical crimping tool with ratchet. Terminals can be crimped very easily by swinging the movable handle. The construction with the built-in-force-blocking device guaranteed a constant and exact crimping depth and therefore an excellent electrical and mechanical quality of the crimping connection. The collapsible tool head enables a quick changing of the die sets. Caused by the crimping force of 100 kN the construction offers an alternative to hydraulic operated tools.

Deliverable die sets

Indent-crimping dies 10-150 mm²

for cable lugs acc. to DIN 46234

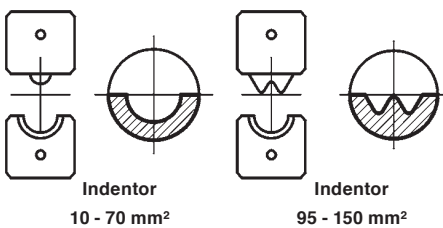

Part-No.	cross-section mm ²	Part-No.	cross-section mm ²
12800	10 + 70	12804	95
12801	16 + 35	12805	120
12802	25 + 50	12806	150
12803	Indenter 10 - 70	12807	Indenter 95 - 150

Remark: When placing an order about indent crimping dies Part-No. 12800-02 and 12804-06 it is necessary to order the suitable indenter too.

WM-crimping 10-240 mm²

for tubular cable lugs
druseidt standard design

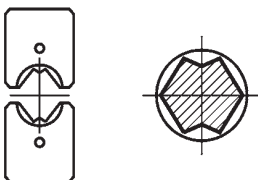

Part-No.	cross-section mm ²	crimping width mm	Part-No.	cross-section mm ²	crimping width mm
12341	10	7	12347	95	7
12342	16	7	12348	120	7
12343	25	7	12349	150	7
12344	35	7	12350	185	7
12345	50	7	12351	240	7
12346	70	7			

WM-crimping 10-240 mm²

for tubular cable lugs
druseidt Euro-type design

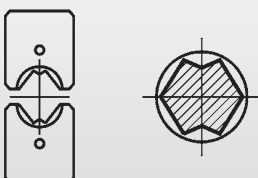

Part-No.	cross-section mm ²	crimping width mm	Part-No.	cross-section mm ²	crimping width mm
12562	10	7	12568	95	7
12563	16	7	12569	120	7
12564	25	7	12570	150	7
12565	35	7	12571	185	7
12566	50	7	12572	240	7
12567	70	7			

Exchangeable die sets for crimping tool Part-No. 31460

WM-crimping 10f-150f mm²

for tubular cable lugs

druseidt design for fine stranded cables

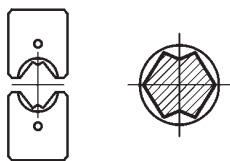

Part-No.	cross-section mm ²	crimping width mm	Part-No.	cross-section mm ²	crimping width mm
12192	10 f	5	12197	70 f	5
12193	16 f	5	12198	95 f	5
12194	25 f	5	12199	120 f	5
12195	35 f	5	12200	150 f	5
12196	50 f	5			

Hexagonal-crimping 10-240 mm²

for copper-cable lugs and connectors

acc. to DIN 46235/46267 part 1

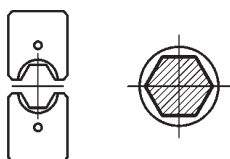

Part-No.	cross-section mm ²	code-no.	crimping width mm	Part-No.	Querschnitt mm ²	code-no.	crimping width mm
12809	10	6	7	12357	95	18	7
12352	16	8	7	12358	120	20	7
12353	25	10	7	12359	150	22	7
12354	35	12	7	12360	185	25	7
12355	50	14	7	12361	240	28	7
12356	70	16	7				

Hexagonal-crimping 10-240 mm²

for aluminium-cable lugs and connectors

acc. to DIN 46329/46267 part 2

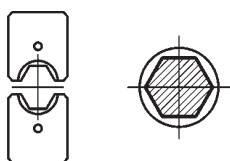

Part-No.	cross-section mm ²	code-no.	crimping width mm	Part-No.	Querschnitt mm ²	code-no.	crimping width mm
12362	16/25	12 Al	7	12366	95/120	22 Al	7
12363	35	14 Al	7	12367	150	25 Al	7
12364	50	16 Al	7	12368	185	28 Al	7
12365	70	18 Al	7	12369	240	32 Al	7

Round-crimping dies 25/35-240/300 mm²

for sector shaped Cu-and Al-conductors

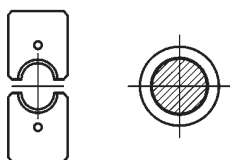

Part-No.	cross-section mm ²		crimping width mm	Part-No.	cross-section mm ²		crimping width mm
	sm	se			sm	se	
12378	25	35	25	12383	120	150	25
12379	35	50	25	12384	150	185	25
12380	50	70	25	12385	185	240	25
12381	70	95	25	12386	240	300	16
12382	95	120	25				

Trapezoid-crimping 25-185 mm²

for cable end sleeves acc. to DIN 46228 part 1 + 4

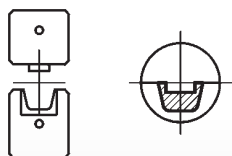

Part-No.	cross-section mm ²	crimping width mm	Part-No.	cross-section mm ²	crimping width mm
12888	25	24	12892	95	24
12889	35	24	12893	120	24
12890	50	24			
12891	70	24			

Oval-crimping 10-150 mm²

for insulated cable lugs

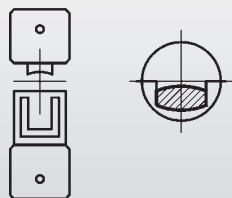

Part-No.	cross-section mm ²	Part-No.	cross-section mm ²
12810	10	12815	70
12811	16	12816	95
12812	25	12817	120
12813	35	12818	150
12814	50		

Remark: Suitable for insulated cable lugs according to catalogue pages 15 + 16.

Hydraulic operated crimping tools with exchangeable die sets 10-240 mm²

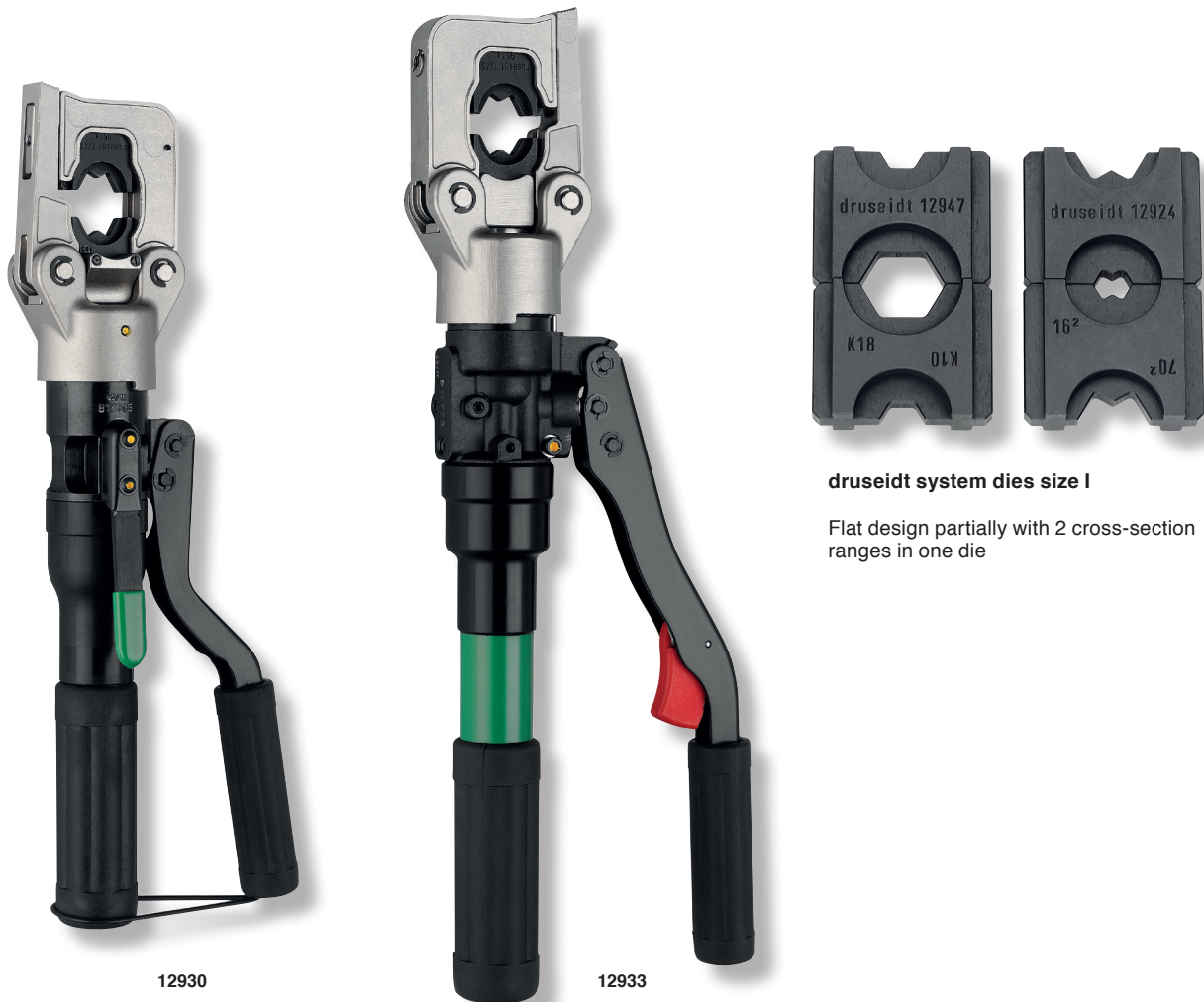

druseidt system dies size I

Flat design partially with 2 cross-section ranges in one die

Part-No.	cross-section range	crimping force	description	length	weight kg/pcs.
12930	1,5 - 240 mm ²	ca. 55 kN	crimping tool with single acting piston pump without die sets	365 mm	2,50
12931	steel carrying case for 12930				
12933	1,5 - 240 mm ²	ca. 55 kN	crimping tool with double acting piston pump without die sets	415 mm	3,30
12934	steel carrying case for 12933				

Remark: Small, handy hydraulic operated crimping tools with limit compression valve. Part-No. 12930 with single and Part-No. 12933 with double acting piston pump for rapid motion of the die set to the connector. The collapsible rotating tool head enables a quick changing of the die sets and a working also in cramped conditions. The tools are equipped with druseidt system die sets (flat design acc. to system I), which can be also used in druseidt battery operated tools Part-No. 14240/42, 12748 resp. 12728.

Range of application/deliverable crimping dies

- **Indent-crimping 6-70 mm²**
for cable lugs acc. to DIN 46234 and 46230
- **Indent-crimping 1,5-35 mm²**
for druseidt stainless steel cable lugs
- **WM-crimping 10-240 mm² for tubular cable lugs**
 - druseidt standard design
 - druseidt Euro-type design
 - druseidt design for fine stranded cables
- **Hexagonal-crimping 10/16-185 mm²**
for cable lugs and connectors
 - copper DIN 46235/46267 part 1
 - aluminium DIN 46329/46267 part 2
- **Trapezoid-crimping 10-95 mm²**
for cable end sleeves acc. to DIN 46228 part 1 + 4
- **Round-crimping dies 25/35-185/240 mm²**
- **Oval crimping dies 10-35 mm²**
for insulated cable lugs and connectors

Selection charts for crimping dies with Part-No. and description are listed in this catalogue on pages 202 and 203.

Hydraulic operated crimping tool
with exchangeable die sets 6-300 mm²



druseidt system dies size II
half shell dies
small design

Part-No.	cross-section range	crimping force	description	length	weight kg/pcs.
12766	6 - 300 mm ²	ca. 62 kN	crimping tool with double acting piston pump without die sets	395 mm	2,80
12767	steel carrying case for 12766				

Remark: Handy hydraulic operated crimping tool with a large operating capacity up to cross-section of 300 mm². Equipped with limit compression valve and double acting piston pump for rapid motion of the die set to the connector. The collapsible rotating tool head with quick fastener enables a quick changing of the die sets. The light and handy design with a length of only 395 mm enables also a working in cramped conditions. The tool is equipped with druseidt system die sets (half shell dies, small design acc. to size II) which can be also used in druseidt battery operated tools Part-No. 13552 and 14240/41, 12724 as well as in druseidt hydraulic crimping-heads Part-No. 12836.

Range of application/deliverable crimping dies

- **Indent crimping 10-70 mm²**
for cable lugs DIN 46234 + DIN 46230
- **Indent crimping 1,5-35 mm²**
for druseidt stainless steel cable lugs
- **WM-crimping 10-300 mm²**
for tubular cable lugs and connectors
- druseidt standard design
- druseidt Euro-type design
- **WM-crimping 10-240 mm²**
for druseidt tubular cable lugs and connectors
- druseidt design for fine stranded cables
- **Hexagonal crimping 6-300 mm²**
For cable lugs and connectors
- Copper DIN 46235/DIN 46267 part 1
- Aluminium DIN 46329/DIN 46267 part 2
- **Round crimping dies 25/35-185/240 mm²**
- **Trapezoid crimping 10-240 mm²**
for cable end sleeves DIN 46228 part 1 + 4
- **Trapezoid crimping 4-16 mm²**
for Twin cable end sleeves 2 x 4 mm² up to 2 x 16 mm²
- **Crimping dies for C- and H-shaped connectors on request**

Selection charts for crimping dies with Part-No. and description are listed in this catalogue on pages 204 and 205.

Hydraulic operated crimping tools with exchangeable die sets 10-300 mm²



Part-No.	cross-section range	crimping force	description	length	weight kg/pcs.
12965/S	10 - 300 mm ²	ca. 130 kN	crimping tool with single acting piston pump without die sets	570 mm	6,10
12966	steel carrying case for 12965/S				
12968	10 - 300 mm ²	ca. 130 kN	crimping tool with double acting piston pump without die sets	510 mm	6,10
12969	steel carrying case for 12968				

Remark: Hand operated hydraulic crimping tools with high crimping force and rotating C-shaped crimping heads. Part-No. 12965/S with single acting piston pump and adjustable reverse running position. So it is possible to crimp connectors with the same cross-section very quick and economically by realizing the crimping process only with a few strokes. To protect the tool against damaging and pollution it is equipped with completely rubber insulated handles. The C-shaped crimping head enables a side placing of cables and connectors up to 22 mm outside-Ø. Tool Part-No. 12968 is constructed in a shorter design but with a double acting piston pump for rapid motion of the die sets to the connector. The opening of the crimping head enables a side placing of cables and connectors up to an outside-Ø of 25 mm. The high crimping force of both tools realizes a working with crimping dies in a large design. So it is possible to reduce the number of crimpings, when working with bigger cross-sections. The tools are designed for using druseidt system dies size III (half shell dies in large design), which can be also used in druseidt battery operated tools Part-No. 13551/25, 13551/42 and 13537 as well as in druseidt hydraulic crimping heads Part-No. 12485, 12486, 12487 or table top unit 12837.

Range of application/deliverable crimping dies

- **Indent crimping 10-240 mm²**
for cable lugs DIN 46234 + DIN 46230
- **Indent crimping 10-95 mm²**
for druseidt stainless steel cable lugs
- **WM-crimping 10-300 mm²**
for tubular cable lugs and connectors
- druseidt standard desin
- druseidt Euro-type design
- **WM-crimping 10-240 mm²**
for druseidt tubular cable lugs and connectors
- druseidt design for fine stranded cables
- **Hexagonal crimping 10-300 mm²**
For cable lugs and connectors
- Copper DIN 46235/DIN 46267 part 1
- Aluminium DIN 46329/DIN 46267 part 2
- **Round crimping dies 25/35-240/300 mm²**
- **Trapezoid crimping 25-185 mm²**
for cble end sleeves DIN 46228 part 1 + 4
- **Crimping dies for C- and H-shaped connectors on request**

Selection charts for crimping dies with Part-No. and description are listed in this catalogue on pages 206 and 207.

druseidt battery operated tool program:
Electro-hydraulic operated crimping- and cutting tools
for industrial as well as applications in craft

**Economically
Productive
Universal applicable**

● **Battery operated tools with fixed tool heads**

- crimping system 60 kN with collapsible tool head
- crimping system 130 kN with C-shaped tool head
- crimping system 130 kN with H-shaped tool head
- cutting system up to 50 mm Ø
- cutting system up to 85 mm Ø

● **Battery operated tools with exchangeable tool-heads**

- crimping/cutting system 60 kN
- crimping/cutting system 100 kN

● **Battery operated tools in cylindrical shaped design**

- druseidt system "Standard"
- druseidt system "Mini"



Battery operated
crimping tool 130 kN
with shoulder strap

Highest quality „made in Germany“

druseidt's battery operated electro-hydraulic crimping and cutting tools offer an excellent solution for mobile applications as well as working in cramped conditions. The new tool generation is characterized by a modern process- and control technology combined and equipped with Li-Ion- batteries and a USB-interface to connect them with all popular PC-systems. The included analysis software allows an interpretation of the crimping process and offers services- and monitoring functions too. Additionally all tools are equipped with an optical failure- and stand-by indication system. So a maximum of performance, safety and controlling is guaranteed.

Especially for switch gear builders who work only in a cross-section range up to 120 mm² and do not need so much electronic performances, we offer an extremely handy battery operated crimping tool in cylindrical shape design called "druseidt Mini". This tool offers an economically work in a very good price performance. For applications up to a cross-section range of 240 mm² we offer a bigger one called "druseidt Standard". This tool is equipped with the same extensive electronic performances like the tools in pistol-design.



Battery operated crimping/cutting tool 100 kN with exchangeable tool heads

Additionally to our product range of crimping and cutting tools in pistol- as well as cylindrical shaped design with fixed tool heads, we deliver systems (crimping/cutting) with exchangeable tool heads too. Especially the tools with the exchangeable tool heads offer an excellent performance in matters of cost effectiveness and mobility.



Battery operated crimping tool 60 kN with fixed tool head

**Battery operated hydraulic crimping and cutting tool 60 kN
druseidt-system with exchangeable tool heads**



14241

Crimping



14242



14243

Cutting



14244

Deliverable exchangeable tool heads

- universal battery operated hydraulic crimping and cutting tool with exchangeable tool heads
- deliverable tool heads
- **Part-No. 14241** collapsible crimping head for half shell dies
- **Part-No. 14242** collapsible crimping head for flat dies
- **Part-No. 14243** cutting head for copper and aluminium cables max. Ø 65 mm
- **Part-No. 14244** cutting head for ACSR-cables max. Ø 55 mm
- two stage hydraulic system with quick feed and power stroke
- collapsible, 360° rotating tool heads

- automatic pressure limit and monitoring by a pressure sensor
- electronic control and inspection of the crimping cycle
- quick motor stop and manual retraction
- automatic motor stop and automatic retraction once crimp is completed (the automatic retraction function can be switched off in case of need)
- USB-interface for remote diagnosis analysis software with interpretation-, service- and monitoring function
- optical failure- and stand-by indication system
- high performance Lithium-Ion-battery
- 230 V mains adapter as accessory part

Battery operated hydraulic crimping and cutting tool 60 kN druseidt-system with exchangeable tool heads



die-sets for crimping head Part-No. 14241
druseidt system dies size II
half shell dies in small design



die-sets for crimping head Part-No. 14242
druseidt system dies size I
flat design

Part-No.	cross-section range	description/scope of supply	
14240	1,5 - 300 mm ²	1 standard set consisting out of:	1 piece battery charger 230 V
		1 piece battery operated basic unit 60 kN without tool heads	1 piece analysis software
		1 piece Li-Ion-battery 14,4 V, 2,6 Ah	1 piece USB-connecting lead
14241		crimping head for half shell dies	
14242		crimping head for flat dies	
14243		cutting head for copper- and aluminium-cables up to 65 mm Ø	
14244		cutting head for ACSR-cables up to 45 mm Ø	
14245		steel carrying case	
Accessories			
13553	Replacement Li-Ion-battery 14,4 V, 2,6 Ah		
13554	Replacement battery charger 230 V		
13555	230 V mains adapter with 5 m connecting lead		
13538	Shoulder strap		
Technical data			
<ul style="list-style-type: none"> • crimping force: 60 kN • max. stroke: 55 mm • operating pressure: 700 bar • Li-Ion-battery 14,4 V/2,6 Ah • crimping time: 3-6 sec. (in dependence of the cross-section) • time of loading: ca. 45 min. • battery charger: 230 V/50 Hz with 2 m connecting lead • weight in dependence of the tool head 6,0-7,5 kg 			

Range of application/deliverable crimping dies

Application for crimping heads	Exchangeable tool heads	
	Part-No. 14241	Part-No. 14242
Indent-crimping for cable lugs acc. to DIN 46234 + DIN 46230	10 - 120 mm ²	10 - 70 mm ²
Indent-crimping for druseidt stainless steel cable lugs	1,5 - 35 mm ²	1,5 - 35 mm ²
WM-crimping for tubular cable lugs and connectors		
• druseidt Standard design	10 - 300 mm ²	10 - 300 mm ²
• druseidt Euro-design	10 - 300 mm ²	10 - 300 mm ²
WM-crimping for tubular cable lugs and connectors		
• druseidt design for fine stranded cables	10 - 240 mm ²	10 - 240 mm ²
Hexagonal crimping for tubular cable lugs and connectors		
• copper acc. to DIN 46235/DIN 46267 part 1	6 - 300 mm ²	10 - 300 mm ²
• aluminium acc. to DIN 46329/46267 part 2	10 - 300 mm ²	16 - 300 mm ²
Trapezoid crimping for cable end sleeves acc. to DIN 46228 part 1 + 4	10 - 185 mm ²	25 - 95 mm ²
Trapezoid crimping for twin cable end sleeves	2 x 4 up to 2 x 16 mm ²	-
Oval crimping for insulated cable lugs and connectors	-	10 - 35 mm ²
Crimping dies for C- and H-shaped connectors	on request	-
Application for cutting heads	Part-No. 14243	Part-No. 14244
• Copper/Aluminium-cables	up to 55 mm Ø	-
• ACSR-cables	-	up to 45 mm Ø

Selection charts for crimping dies with Part-No. and description are listed in this catalogue on pages 202-205.

Battery operated hydraulic crimping and cutting tool 100 kN druseidt-system with exchangeable tool heads



Exchangeable tool heads

Crimping head



Cutting head



Deliverable tool heads

- Battery operated tools with exchangeable tool heads offer an economically and mobile crimping of cable lugs and connectors as well as cutting of copper- and aluminium-cables
- Deliverable tool heads
 - **Part-No. 12753** collapsible crimping head for flat dies
 - **Part-No. 12751** cutting head for copper and aluminium cables up to 54 mm Ø
- two stage hydraulic system with quick feed and power stroke
- collapsible, 360° rotating tool head
- automatic pressure limit and monitoring by a pressure sensor
- electronic control and inspection of the crimping cycle
- quick motor stop and manual retraction
- automatic motor stop and automatic retraction once crimp is completed (the automatic retraction function can be switched off in case of need)
- USB-interface for remote diagnosis
- analysis software with interpretation-, service- and monitoring function
- optical failure- and stand-by indication system
- high performance Lithium-Ion battery
- 230 V mains adapter as accessory part

Battery operated hydraulic crimping and cutting tool 100 kN druseidt-system with exchangeable tool heads



Crimping dies
druseidt system dies size I
flat design

Part-No.	cross-section range	description/scope of supply	
12748	10 - 300 mm ²	1 standard set consisting out of: 1 piece battery operated basic unit 100 kN without tool heads 1 piece Li-Ion-battery 14,4 V, 2,6 Ah	1 piece battery charger 230 V 1 piece analysis software 1 piece USB connecting lead
12749		steel carrying case	
12753		crimping head for flat dies	
12751		cutting head for copper- and aluminium cables up to 54 mm Ø	

Accessories

13553	Replacement Li-Ion-battery 14,4 V, 2,6 Ah
13554	Replacement battery charger 230 V
13555	230 V mains adapter with 5 m connecting lead
13538	Shoulder strap

Technical data

<ul style="list-style-type: none"> • crimping force: 100 kN • max. stroke: 17 mm • operating pressure: 700 bar • crimping time: 3-6 sec. (in dependence of the cross-section) 	<ul style="list-style-type: none"> • Li-Ion-battery 14,4 V/2,6 Ah • time of loading: ca. 45 min. • battery charger: 230 V/50 Hz with 2 m connecting lead • weight: with crimping head 5,3 kg with cutting head 6,1 kg
---	---

Application range for crimping head Part-No. 12753

- **Indent-crimping 10-70 mm²**
for cable lugs acc. to DIN 46234 + DIN 46230
- **Indent-crimping 1,5-35 mm²**
for druseidt stainless steel cable lugs
- **WM-crimping 10-300 mm²**
for tubular cable lugs and connectors
- druseidt Standard design
- druseidt Euro-type design
- **WM-crimping 10-240 mm²**
for tubular cable lugs and connectors
- druseidt design for fine stranded cables
- **Hexagonal-crimping 10/16-300 mm²**
for cable lugs and connectors
- copper DIN 46235/DIN 46267 part 1
- aluminium DIN 46329/DIN 46267 part 2
- **Round-crimping dies 25/35-185/240 mm²**
- **Trapezoid-crimping 25-95 mm²**
for cable end sleeves acc. to DIN 46228 part 1 + 4

Application range of cutting head Part-No. 12751

For cutting of copper- and aluminium cables up to a outer-Ø of 54 mm

Selection charts for crimping dies with Part-No. and description are listed in this catalogue on pages 202-203.

**Battery operated hydraulic crimping tool 60 kN
with fixed crimping head**



13555
230 V mains adapter

- Handy crimping tool for economically and mobile crimping operations
- suitable for working with druseidt system dies size II (half shell dies in small design)
- two stage hydraulic system with quick feed and power stroke
- collapsible, 360° rotating tool heads
- automatic pressure limit and monitoring by a pressure sensor
- electronic control and inspection of the crimping cycle
- quick motor stop and manual retraction
- automatic motor stop and automatic retraction once crimp is completed (the automatic retraction function can be switched off in case of need)
- USB-interface for remote diagnosis
- analysis software with interpretation-, service- and monitoring function
- optical failure- and stand-by indication system
- high performance Lithium-Ion-battery
- 230 V mains adapter as accessory part

Battery operated hydraulic crimping tools 60 kN with fixed crimping heads



Crimping dies
druseidt system dies size II
(half shell dies in small design)

Part-No.	cross-section range	description/scope of supply	
13552	1,5 - 300 mm ²	1 standard set consisting out of:	
		1 piece battery operated basic unit 60 kN without die sets	1 piece analysis software
		1 piece Li-Ion-battery 14,4 V, 2,6 Ah	1 piece USB connecting lead
		1 piece battery charger 230 V	1 piece steel carrying case

Accessories

13553	Replacement Li-Ion-battery 14,4 V, 2,6 Ah
13554	Replacement battery charger 230 V
13555	230 V mains adapter with 5 m connecting lead
13538	Shoulder strap

Technical data

- crimping force: 60 kN
- max. stroke: 17 mm
- operating pressure: 700 bar
- crimping time: 3-6 sec.
(in dependence of the cross-section)
- Li-Ion-battery 14,4 V/2,6 Ah
- time of loading: ca. 45 min.
- battery charger: 230 V/50 Hz with 2 m connecting lead
- weight: ca. 4,15 kg

Range of application/deliverable crimping dies

- **Indent-crimping 10-120 mm²**
for cable lugs acc. to DIN 46234 + DIN 46230
- **Indent-crimping 1,3-35 mm²**
for druseidt stainless steel cable lugs
- **WM-crimping 10-300 mm²**
for tubular cable lugs and connectors
- druseidt Standard design
- druseidt Euro-type design
- **WM-crimping 10-240 mm²**
for tubular cable lugs and connectors
- druseidt design for fine stranded cables
- **Hexagonal crimping 6-300 mm²**
for cable lugs and connectors
- copper DIN 46235/DIN 46267 part 1
- aluminium DIN 46329/46267 part 2
- **Round-crimping dies 25/35-185/240 mm²**
- **Trapezoid crimping 10-185 mm²**
for cable end sleeves acc. to DIN 46228 part 1 + 4
- **Trapezoid crimping 2 x 4 mm² - 2 x 16 mm²**
for twin cable end sleeves
- **Crimping dies for C- and H-shaped connectors on request**

Selection charts for crimping dies with Part-No. and description are listed in this catalogue on pages 204-205.

Battery operated hydraulic crimping tools 130 kN with fixed crimping heads



- universal crimping tools for economically and mobile crimping operations
- suitable for working with druseidt system dies size III (half shell dies in large design)
- the large crimping width enables an efficient working with a lower number of crimpings compared with tools with small designed half shell dies
- the C-shaped crimping heads enables a side placing of cables and connectors up to 25 mm or 42 mm outside-Ø. Cables/connectors with a bigger diameter can be crimped and removed with the H-shaped crimping head without problem
- two stage hydraulic system with quick feed and power stroke
- collapsible, 360° rotating tool heads
- automatic pressure limit and monitoring by a pressure sensor
- electronic control and inspection of the crimping cycle
- quick motor stop and manual retraction
- automatic motor stop and automatic retraction once crimp is completed (the automatic retraction function can be switched off in case of need)
- USB-interface for remote diagnosis
- analysis software with interpretation-, service- and monitoring function
- optical failure- and stand-by indication system
- high performance Lithium-Ion-battery
- 230 V mains adapter as accessory part

Battery operated hydraulic crimping tools 130 kN with fixed crimping heads



Crimping dies
druseidt system dies size III
(half shell dies in large design)

Part-No.	cross-section range	description/scope of supply
13551/25	10 - 300 mm ²	1 Standard set consisting out of: 1 piece battery operated C-shaped basic unit 130 kN opening width 25 mm without die sets 1 piece Li-Ion-battery 14,4 V/2,6 Ah 1 piece battery charger 230 V 1 piece analysis software 1 piece USB connecting lead 1 piece steel carrying case
13551/42	10 - 300 mm ²	1 Standard set consisting out of: 1 piece battery operated C-shaped basic unit 130 kN opening width 42 mm without die sets 1 piece Li-Ion-battery 14,4 V/2,6 Ah 1 piece battery charger 230 V 1 piece analysis software 1 piece USB connecting lead 1 piece steel carrying case
13537	10 - 300 mm ²	1 Standard set consisting out of: 1 piece battery operated H-shaped basic unit 130 kN without die sets 1 piece Li-Ion-battery 14,4 V/2,6 Ah 1 piece battery charger 230 V 1 piece analysis software 1 piece USB connecting lead 1 piece steel carrying case

Accessories

13553	Replacement Li-Ion-battery 14,4 V, 2,6 Ah
13554	Replacement battery charger 230 V
13555	230 V mains adapter with 5 m connecting lead
13538	Shoulder strap

Technical data

- crimping force: 130 kN
- operating pressure: 700 bar
- crimping time: 7,8-13,5 sec.
(in dependence of the cross-section)
- Li-Ion-battery 14,4 V/2,6 Ah
- time of loading: ca. 45 min.
- battery charger: 230 V/50 Hz with 2 m connecting lead
- weight with C-shaped crimping head: ca. 6,9 kg
- weight with H-shaped crimping head: ca. 6,3 kg

Range of application/deliverable crimping dies

- **Indent-crimping 10-240 mm²**
for cable lugs acc. to DIN 46234 + 46230
- **Indent-crimping 10-95 mm²**
for druseidt stainless steel cable lugs
- **WM-crimping 10-300 mm²**
for tubular cable lugs and connectors
- druseidt Standard design
- druseidt Euro-type design
- **WM-crimping 10-240 mm²**
for tubular cable lugs and connectors
- druseidt design for fine stranded cables
- **Hexagonal crimping 10-300 mm²**
for cable lugs and connectors
- copper DIN 46235/DIN 46267 part 1
- aluminium DIN 46329/46267 part 2
- **Round-crimping dies 25/35 - 240/300 mm²**
- **Trapezoid crimping 25-185 mm²**
for cable end sleeves acc. to DIN 46228 part 1 + 4
- **Crimping dies for H-shaped connectors 70-120 mm²**

Selection charts for crimping dies with Part-No. and description are listed in this catalogue on pages 206-207.

**Battery operated hydraulic cutting tools 60 kN
for copper- and aluminium-cables up to 50 mm Ø**



- universal cutting tool
- suitable for cutting copper- and aluminium-cables without core wire
- two stage hydraulic system with quick feed and power stroke
- collapsible, 360° rotating cutting head
- automatic pressure limit and monitoring by a pressure sensor-
electronic control and inspection of the cutting cycle
- quick motor stop and manual retraction
- automatic motor stop and automatic retraction
- USB-interface for remote diagnosis
- analysis software with interpretation-, service- and monitoring function
- optical failure- and stand-by indication system
- high performance Lithium-Ion-battery
- 230 mains adapter as accessory part

Part-No.	cutting force	max. cutting-Ø	description/scope of supply	
13534	60 kN	50 mm	1 Standard set consisting out of:	
			1 piece cutting tool 60 kN	1 piece analysis software
			1 piece Li-Ion-battery 14,4 V, 2,6 Ah	1 piece USB connecting lead
			1 piece battery charger 230 V	1 piece steel carrying case

Accessories

13553	Replacement Li-Ion-battery 14,4 V, 2,6 Ah		
13554	Replacement battery charger 230 V		
13555	230 V mains adapter with 5 m connecting lead		
13538	Shoulder strap		

Technical data

- crimping force 60 kN
- operating pressure 700 bar
- weight 5,6 kg
- Li-Ion-battery 14,4 V/2,6 Ah
- time of loading ca. 45 min.
- battery charger 230 V/50 Hz with 2 m connecting lead

The cutting tools are not applicable for cutting steel-wires, cables with steel inserts or solid conductors. They are also not applicable for all kind of live line working.

Battery operated hydraulic cutting tool 70 kN for copper- and aluminium-cables up to 85 mm Ø



- universal cutting tool
- suitable for cutting copper- and aluminium-cables without core wire
- two stage hydraulic system with quick feed and power stroke
- collapsible, 360° rotating cutting head
- automatic pressure limit and monitoring by a pressure sensor
- electronic control and inspection of the cutting cycle
- quick motor stop and manual retraction
- automatic motor stop and automatic retraction
- USB-interface for remote diagnosis
- analysis software with interpretation-, service- and monitoring function
- optical failure- and stand-by indication system
- high performance Lithium-Ion-battery
- 230 mains adapter as accessory part

Part-No.	cutting force	max. cutting-Ø	description/scope of supply	
13535	70 kN	85 mm	1 Standard set consisting out of:	
			1 piece cutting tool 70 kN	1 piece analysis software
			1 piece Li-Ion-battery 14,4 V, 2,6 Ah	1 piece USB-connecting lead
			1 piece battery charger 230 V	1 piece steel carrying case

Accessories

13553	Replacement Li-Ion-battery 14,4 V, 2,6 Ah		
13554	Replacement battery charger 230 V		
13555	230 V mains adapter with 5 m connecting lead		
13538	Shoulder strap		

Technical data

- crimping force 70 kN
- operating pressure 700 bar
- weight 7,3 kg
- Li-Ion-battery 14,4 V/2,6 Ah
- time of loading ca. 45 min.
- battery charger 230 V/50 Hz with 2 m connecting lead

The cutting tools are not applicable for cutting steel-wires, cables with steel inserts or solid conductors. They are also not applicable for all kind of live line working.

**Battery operated hydraulic crimping tool 35 kN
“druseidt Mini”**

Crimping dies
for “druseidt Mini”

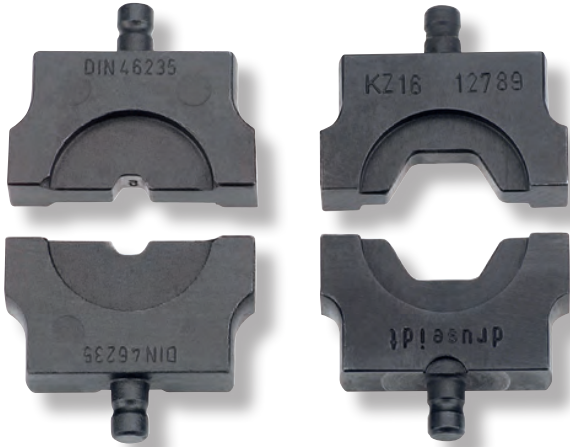

- extremely handy crimping tool with small, collapsible crimping head
- the light weight and the cylindrical shaped design offer a working in cramped conditions too
- two stage hydraulic system with quick feed and power stroke
- well suited for working in a cross-section range up to 120 mm² and users who do not need so much electronic performances
- simply and uncomplicated handling
- with 360° rotating crimping head
- quick motor stop and manual retraction
- for application > 120 mm² we recommend our bigger cylindrical battery operated hydraulic crimping tool “druseidt-standard” deliverable with the whole electronic performances and analysis software according to the catalogue page 186

Part-No.	cross-section range	description/scope of supply
12725	10 - 120 mm ²	1 Standard set consisting out of: 1 piece crimping tool 35 kN without die sets 1 piece Li-Ion-battery 18 V, 1,5 Ah 1 piece battery charger 230 V 1 piece steel carrying case
Accessories		
12726	Replacement Li-Ion-battery 18 V, 1,5 Ah	
12727	Replacement battery charger 230 V	
Technical data		
<ul style="list-style-type: none"> ● crimping force: 35 kN ● operating pressure: 700 bar ● Li-Ion-battery 18 V/1,5 Ah ● battery charger: 230 V, 50 Hz with 2 m connecting lead I 		<ul style="list-style-type: none"> ● crimping time: 3-6 sec. (in dependence of the cross-section) ● weight: 2,1 kg ● length: 360 mm

Range of application/deliverable crimping dies

- **Indent-crimping 10-35 mm²**
for cable lugs acc. to DIN 46234 + 46230
- **WM-crimping 10-120 mm²**
for tubular cable lugs and connectors
- druseidt Standard design
- druseidt Euro-type design
- **WM-crimping 10-95 mm²**
for tubular cable lugs and connectors
- druseidt design for fine stranded cables
- **Hexagonal crimping 10/16-95 mm²**
for cable lugs and connectors
- copper DIN 46235/DIN 46267 part 1
- aluminium DIN 46329/46267 part 2

Exchangeable die sets for crimping tool "druseidt-Mini"

Indent-crimping 10-35 mm²

for cable lugs acc. to DIN 46234 + DIN 46230

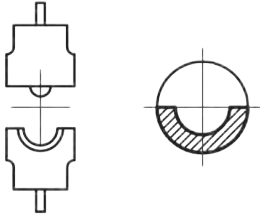

Part-No.	cross-section mm ²
12548	10
12549	16
12550	25
12551	35

WM-crimping 10-120 mm²

for tubular cable lugs and connectors
druseidt Standard design

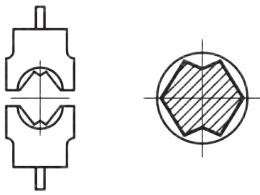

Part-No.	cross-section mm ²	crimping width mm
12792	10	5
12793	16	5
12794	25	5
12795	35	5
12796	50	5
12797	70	5
12798	95	5
12799	120	5

WM-crimping 10-120 mm²

for tubular cable lugs and connectors
druseidt Euro-type design

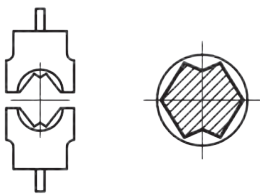

Part-No.	cross-section mm ²	crimping width mm
12554	10	5
12555	16	5
12556	25	5
12557	35	5
12558	50	5
12559	70	5
12560	95	5
12561	120	5

WM-crimping 10-95 mm²

for tubular cable lugs and connectors
druseidt design for fine stranded cables

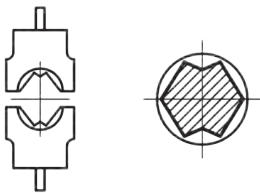

Part-No.	cross-section mm ²	crimping width mm
12740	10	5
12741	16	5
12742	25	5
12743	35	5
12744	50	5
12745	70	5
12746	95	5

Hexagonal crimping 10-95 mm²

for cable lugs and connectors
copper DIN 46235/DIN 46267 part 1
aluminium DIN 46329/DIN 46267 part 2

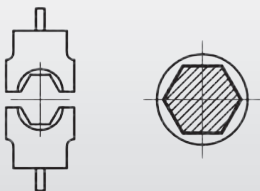

Part-No.	code-no.	cross-section mm ²		crimping width mm
		Cu	Al	
12784	6	10	-	5
12785	8	16	-	5
12786	10	25	-	5
12787	12	35	16/25	5
12788	14	50	35	5
12789	16	70	50	5
12790	18	95	70	5

Battery operated hydraulic crimping tool 50 kN, “druseidt Standard“ in bar-shaped design with exchangeable crimping dies 1,5 up to 240 mm²



crimping dies
druseidt system dies size I
(flat dies)

- handy crimping tool in bar-shaped design offers a wide range of crimping performances
- equipped with the same electronic functions like the battery operated tools in pistol design
- well suited for a fatigue-free working also when crimping bigger cross-sections
- two stage hydraulic-system with quick feed and power stroke
- collapsible 360° rotating crimping head
- automatic pressure limit and monitoring by a pressure sensor
- quick motor stop and manual retraction option
- automatic motor stop and automatic retraction once crimp is completed (the automatic retraction function can be switched off in case of need)
- USB-interface for remote diagnosis
- analysis software with interpretation-, service- and monitoring function
- optical failure- and stand-by indication system

Battery operated hydraulic crimping tool 50 kN "druseidt Standard" in bar-shaped design with exchangeable crimping dies 1,5 up to 240 mm²



Part-No.	cross-section range	description/scope of supply
12728	1,5 - 240 mm ²	1 standard set consisting out of: 1 piece crimping tool 50 kN without die sets 1 piece Li-Ion-battery 18 V/1,5 Ah 1 piece battery charger 230 V 1 piece analysis software 1 piece USB connecting lead 1 piece steel carrying case

Accessories

12726	Replacement Li-Ion-battery 18 V/1,5 Ah
12727	Replacement battery charger 230 V

Technical data

- crimping force 50 kN
- operating pressure 700 bar
- Li-Ion-battery 18 V/1,5 Ah
- time of loading ca. 45 minutes
- battery charger 230 V with 2 m connecting lead
- crimping time 3-6 sec.(in dependence of the cross-section)
- weight 2,8 kg
- length 400 mm

Range of application/deliverable crimping dies

- **Indent-crimping 10-70 mm²**
for cable lugs acc. to DIN 46234 + DIN 46230
- **Indent-crimping 1,5-35 mm²**
for druseidt stainless steel cable lugs
- **WM-crimping 10-240 mm²**
for tubular cable lugs and connectors
- druseidt Standardseries
- druseidt Euroseries
- **WM-crimping 10-185 mm²**
for tubular cable lugs an connectors
- druseidt design for fine stranded cables
- **Hexagonal-crimping 10/16-185 mm²**
for cable lugs and connectors
- copper DIN 46235/DIN 46267 part 1
- aluminium DIN 46329/DIN 46267 part 2
- **Round-crimping dies 25/35-185/240 mm²**
- **Trapezoid crimping 10-95 mm²**
for cable end sleeves acc. to DIN 46228 part 1 + 4

Selection charts for crimping dies with Part-No. and description are listed in this catalogue on pages 202-203.

**Battery operated hydraulic crimping tool 60 kN in bar-shaped design
with foldable crimping head and exchangeable crimping dies 1,5 up to 300 mm²**



Crimping dies
druseidt-System dies size II
(half shell dies in small design)

- handy crimping tool in bar-shaped design offers a wide range of crimping performances
- equipped with the same electronic functions like the battery operated tools in pistol design
- well suited for a fatigue-free working also when crimping bigger cross-sections
- two stage hydraulic-system with quick feed and power stroke
- collapsible 360° rotating crimping head
- automatic pressure limit and monitoring by a pressure sensor
- quick motor stop and manual retraction option
- automatic motor stop and automatic retraction once crimp is completed (the automatic retraction function can be switched off in case of need)
- USB-interface for remote diagnosis
- analysis software with interpretation-, service- and monitoring function
- optical failure- and stand-by indication system

Battery operated hydraulic crimping tool 60 kN in bar-shaped design with foldable crimping head and exchangeable crimping dies 1,5 up to 300 mm²



Part-No.	cross-section range	description/scope of supply
12724	1,5 - 300 mm ²	1 standard set consisting out of: 1 piece crimping tool 60 kN without die sets 1 piece Li-Ion-battery 18 V/1,5 Ah 1 piece battery charger 230 V 1 piece analysis software 1 piece USB connecting lead 1 piece steel carrying case

Accessories

12726	Replacement Li-Ion-battery 18 V/1,5 Ah
12727	Replacement battery charger 230 V

Technical data

- crimping force 60 kN
- operating pressure 700 bar
- Li-Ion-battery 18 V/1,5 Ah
- time of loading ca. 45 minutes
- battery charger 230 V with 2 m connecting lead
- crimping time 3-6 sec.(in dependence of the cross-section)
- weight 2,8 kg
- length 400 mm

Range of application/deliverable crimping dies

- **Indent-crimping 10-120 mm²**
for cable lugs acc. to DIN 46234 + DIN 46230
- **Indent-crimping 1,5-35 mm²**
for druseidt stainless steel cable lugs
- **WM-crimping 10-300 mm²**
for tubular cable lugs and connectors
- druseidt Standardseries
- druseidt Euroseries
- **WM-crimping 10-240 mm²**
for tubular cable lugs an connectors
- druseidt design for fine stranded cables
- **Hexagonal-crimping 6-300 mm²**
for cable lugs and connectors
- copper DIN 46235/DIN 46267 part 1
- aluminium DIN 46329/DIN 46267 part 2
- **Round-crimping dies 25/35-185/240 mm²**
- **Trapezoid crimping 10-240 mm²**
for cable end sleeves acc. to DIN 46228
part 1 + 4
- **Trapazoid crimping 2 x 4 mm² - 2 x 16 mm²**
for Twin cable end sleeves
- **Crimping dies for C- and H-shaped connectors on request**

Selection charts for crimping dies with Part-No. and description are listed in this catalogue on pages 204-205.

Battery operated hydraulic cutting tool 30 kN for stranded copper- and aluminium cables up to 40 mm Ø



- Handy cutting tool with open cutting head and endless rotation
- Suitable for cutting stranded copper- and aluminium cables without core wire
- Ideal for mobile use
- Automatic pressure limit and monitoring by a pressure sensor
- Automatic cutting detection with motor cut-off and automatic return after completed cutting process
- Quick motor stop and manual return option
- Electronic control and inspection of the cutting cycle
- USB interface for connection to all common computer systems
- Analysis software with interpretation-, service- and monitoring function
- Optimal failure- and stand-by indication system
- Charge status display directly on the battery



Part-No.	cutting-force	max. cutting-Ø	Discription/scope of supply
12721	30 kN	40 mm	1 Standard-Set consisting out of: 1 piece cutting tool 1 piece Li-Ion battery 18 V, 1,5 Ah 1 piece battery charger 230 V 1 piece analysis software 1 piece USB-connecting cable 1 piece steel carrying case

Accessories

12726	Replacement Li-Ion battery 18 V, 1,5 Ah
12727	Replacement battery charger 230 V/50 Hz

Technical data

- cutting force 30 kN
- operating pressure: 700 bar
- weight: 2,8 kg
- Li-Ion battery 18 V, 1,5 Ah
- time of loading: ca. 45 minutes
- battery charger: 230 V with 2 m connecting cable
- cutting ranges
copper 1 x 240 mm² or 4 x 50 mm²
aluminium 1 x 500 mm² or 4 x 70 mm²

The cutting tools are not applicable for cutting steel-wires, cables with steel inserts or solid conductors and for for all kind of life working.

Hydraulic working systems with exchangeable compression- and cutting heads

When working continuously with bigger cross-sections or equipping fixed workplaces druseidt offers an extensive program of hydraulic working systems consisting out of hydraulic pumps and different crimping and cutting units. To offer a mobile working too also new designed light and handy battery operated hydraulic pumps are besides the traditional pumps part of the delivery program. So all users get the opportunity to order for his crimping and cutting procedures an individual hardware configuration, exactly coordinated with his application. To complement the workplaces with the right stripping technology (described on catalogue pages 141 ff) corresponding different stripping devices are offered too. So all users get the possibility to order mobile as well as stationary systems and are able to equip their workplaces with the right and best practical devices. A detailed consultation about stripping, cutting and crimping solutions as well as a support in the range of quality management are the basis for realizing reproducible electrical cable connections. So our employees will be glad to provide consultation to support your plans.

druseidt hydraulic working systems

- foot operated pumps
- different sizes of electrohydraulic pumps
- battery operated electrohydraulic pumps
- hydro-pneumatically actuated pumps

druseidt exchangeable crimping units

- system 60 kN
 - system 130 kN
 - system 250 kN
 - system 450 kN
- for a cross-section range up to 1000 mm²

druseidt exchangeable cutting units

- system 60 kN
 - system 70 kN
 - system 130 kN
- for copper- and aluminium-cables up to a outer-Ø of 95 mm
resp. ACSR-cables up to outer-Ø of 45 mm



Hydraulic pumps and accessories

suitable for working with our crimping- and cutting heads
with an operating pressure of 700 bar

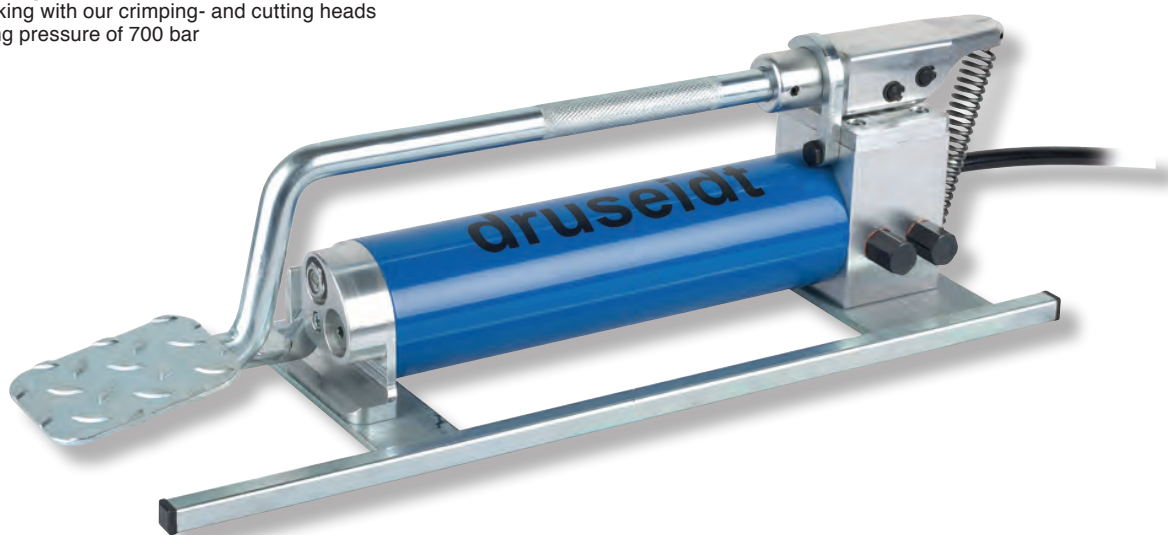

Part-No.	operating pressure	description/scope of supply
12480	700 bar	Hydraulic foot pump with 2 m high pressure hose and quick coupling without tool heads
Technical data		
<ul style="list-style-type: none"> • operating pressure: 700 bar • oil filling: 1 liter • operating temperature: -20° C up to +40° C 		<ul style="list-style-type: none"> • dimensions: 170 mm x 190 mm x 660 mm • weight: 9 kg
<p>Remark: Two stage hydraulic foot pump with safety valve, automatic changeover switching and as needed manuell return travel also when working in the high pressure range.</p>		



Part-No.	operating pressure	description/scope of supply
05254	700 bar	Electro-hydraulic pump with 1,8 m high pressure hose, hand switch and quick coupling without tool heads
05253		Double foot pedal for elcetro-hydraulic pump 05254
Technical data		
<ul style="list-style-type: none"> • operating pressure: 700 bar • operating voltage: 230 V/50 Hz • nominal capacity: 0,4 kW • delivery rate: 0-20 bar 2 l/min 		<ul style="list-style-type: none"> • delivery rate: 20-700 bar 1,2 l/min • useable oil volume: 0,8 liter, oil filling 1,2 liter • dimensions: 300 mm x 150 mm x 285 mm • weight: 8 kg
<p>Remark: handy two stage electro-hydraulic pump with pressure limiting valve and automatic changeover switching. Caused by the light weight and the small dimensions also well suited for mobile working.</p>		

Electro-hydraulic pumps with accessories

suitable for working with our crimping- and cutting heads with an operating pressure of 700 bar



Part-No.	operating pressure	tank volume	description
05270	700 bar	2 Liter	Electro-hydraulic pump without tool heads and high pressure hose
05272	700 bar	5 Liter	Electro-hydraulic pump without tool heads and high pressure hose
05274			Hand switch
05275			Foot switch

technical data

- operating pressure: 700 bar
- operating voltage: 230 V/50 Hz
- 4-cylinder pump with quick feed
- high pressure delivery rate: 0,34 l/min
- low pressure delivery rate: 0,80 l/min
- Aluminum-box with steel tank
- Motor rating: 370 W (4-phase motor)

Part-No. 05270

- Tank volume: 2 liter
- useable oil volume: 1,8 liter
- dimensions: 380/430 mm x 210 mm x 395 mm
- weight 15 kg

Part-No. 05272

- Tank volume: 5 liter
- useable oil volume: 4 liter
- dimensions: 385/435 mm x 245 mm x 420 mm
- weight: 20 kg

Remark: Two stage electro-hydraulic pumps with pressure limiting valve and automatic changeover switching. All pumps can be actuated by a hand switch/remote control or alternatively by a foot pedal with automatic safety device. Therefore when ordering a pump please be so kind and order the needed switch separately. The pumps will be actuated by pressing the switch and then the pumps open automatically when the operating pressure is achieved. At any time, in the high pressure as well as in the low pressure range, it is possible to break the operation and to open the pump immediately.

High pressure hoses with quick coupling

suitable for connecting our crimping- and cutting heads with an operating pressure of 700 bar



Part-No.	description
05258	with steel mesh inlay, non-insulating, 2 m length
05259	with steel mesh inlay, non-insulating, 3 m length
05260	with steel mesh inlay, non-insulating, 4 m length
05262	with steel mesh inlay, non-insulating, 5 m length

Battery operated electro-hydraulic pump

suitable for working with our crimping- and cutting heads
with an operating pressure of 700 bar



Standard set including accessories

- Light, compact and robust construction with fiber-glass reinforced, non conducting and shock proof, body out of Polyamide. Therefore well suited for mobile application.
- The system has extremely rapid advancement thanks to a special double piston-technology, characterized by a low-pressure- and a slow high-pressure advancement.
- Quick tool return by high return conveyor volumetric guarantees quick working cycles.
- Equipped with a capacity recognition system that permits precise work with or without the hydraulic hose (the machine may be connected directly to the pump).
- The motor is adjusted with PWM (soft start to save the transmission, motor and battery).
- The return stroke of the tool head is controlled by a software.
- Control of the equipment is realized through a micro-controller.
- Pressure control is performed by an electronic pressure sensor.
- The charge of the power pack is kept constantly under control.
- The traceability of work cycles is ensured through automatic registration and saving in the machine memory. Management of technical assistance is performed with an electronic system and the included analysis software.
- The data saved can be read and the software can be updated through a mini USB interface.
- Actuation through the hand switch/remote control.
- Additionally LED indicators provide rapid information on the status of the machine.
- Retraction optionally automatically or manually with retraction stop function.

Part-No.	operating pressure	description/scope of supply	
05265	700 bar	1 Standard set consisting out of:	
		- 1 piece battery operated pump without tool heads	- 1 piece high pressure hose 1,5 m
		- 1 piece Li-Ion-battery 18 V, 3,0 Ah	- 1 piece shoulder strap
		- 1 piece battery charger 230 V, 50 Hz	- 1 piece carry bag with additional pockets
		- 1 piece analysis software	
		- 1 piece USB connecting lead	

Accessories

12726/3,0	Replacement Li-Ion-battery 18 V, 3,0 Ah
12727	Replacement battery charger 230 V for Li-Ion-battery 18 V
12729	230 V mains adapter 18 V with 5 m connecting lead
05267	high pressure hose with quick coupling 1,5 m length
05268	high pressure hose with quick coupling 1,5 m length
05269	high pressure hose with quick coupling 10 m length

Technical data

- operating pressure: 700 bar (70 MPa)
- delivery rate: 1,15 l/min (low-pressure range)
0,15 l/min (high pressure range)
- automatic conversation from low to high pressure takes place at approximately 90 bar
- with DC-motor
- Li-Ion-battery 18 V DC, 3,0 Ah
- battery charger: 230 V, 50 Hz with 2 m connecting lead
- time of loading: ca. 45-50 min.
- operating temperature: -20° C up to +55° C
- protection class: IP 43
- dimensions: 300 mm x 195 mm x 210 mm
- weight: ca. 4,7 kg

Battery operated electro-hydraulic pump

with additional integrated display and additional functions suitable for working with our crimping- and cutting heads with an operating pressure of 700 bar



Standard set including accessories

Design according to the description of battery operated pump Part-No. 05265 page 190 but with additional integrated display and following additional functions:

- The progress of compression can be shown on the display (pressure and operating time)
- Pressure control indication
- Error message (crimping error, temperature, battery self-diagnosis)
- Indication of service and machine data
- In drive (knob) input and output element
- Possibility for working with preinstalled standard programs for crimping or cutting with:
 - Automatic or manual return flow
 - Hold time setting
 - Instep function by means of an automatic adjustment
 - Return stop function
 - Immediate cutting opening after cut and letting go the button (automatic cutting detection)
- Storable operator program

Part-No.	operating pressure	description/scope of supply	
05266	700 bar	1 Standard set consisting out of:	
		- 1 piece battery operated pump without tool heads	- 1 piece high pressure hose 1,5 m length
		- 1 piece Li-Ion-battery 18 V, 3,0 Ah	- 1 piece shoulder strap
		- 1 piece battery charger 230 V, 50 Hz	- 1 piece carry bag with additional pockets
		- 1 piece analysis software	
		- 1 piece USB connecting lead	

Accessories

12726/3,0	Replacement Li-Ion-battery 18 V, 3,0 Ah
12727	Replacement battery charger 230 V for Li-Ion-battery 18 V
12729	230 V mains adapter 18 V with 5 m connecting lead
05267	high pressure hose with quick coupling 1,5 m length
05268	high pressure hose with quick coupling 5 m length
05269	high pressure hose with quick coupling 10 m length

Technical data

- operating pressure: 700 bar (70 MPa)
- delivery rate: 1,15 l/min (low-pressure range)
0,15 l/min (high pressure range)
- automatic conversation from low to high pressure takes place at approximately 90 bar
- with DC-motor
- Li-Ion-battery 18 V DC, 3,0 Ah
- battery charger: 230 V, 50 Hz with 2 m connecting lead
- time of loading: ca. 45-50 min.
- operating temperature: -20° C up to +55° C
- protection class: IP 43
- dimensions: 300 mm x 195 mm x 210 mm
- weight: ca. 4,7 kg

Hydro-pneumatically actuated pumps

suitable for working with our crimping- and cutting heads with an operating pressure of 700 bar

- Ergonomically designed high performance pumps
- Well suited for working with our crimping- and cutting heads with 700 bar operating pressure
- Stable and compact design with relatively low weight
- The incoming air pressure is converted into a high hydraulic operating pressure via a pressure intensifier
- The pumps are operated by a foot pedal so that both hands are free for other activities
- Inexpensive and universally applicable



Part-No.	operating pressure	tank volume	description
05276	700 bar	2,4 l	Hydro-pneumatically actuated food pumps with 2 m long high pressure
05286	700 bar	5,0 l	hose and quick coupling
05277			High pressure hose 3 m long one side AG 3/8" NPT - other side Cejn quick coupling
05278			High pressure hose 4 m long one side AG 3/8" NPT - other side Cejn quick coupling
05279			High pressure hose 6 m long one side AG 3/8" NPT - other side Cejn quick coupling
05280			High pressure hose 10 m long one side AG 3/8" NPT - other side Cejn quick coupling

Technical data

- Required air pressure: max. 6 bar
- Operating pressure: max. 700 bar
- Tank volume: 2,4 l / 5,0 l
- Oil flow rate: up to 2,7 l/min
- Dimensions:
05276: 365 x 155 x 109 mm, 05286: 365 x 178 x 137 mm
- Weight:
05276: 6,3 kg, 05286: 10,2 kg
- Low noise: ca. 75 dbA
- Air consumption: 400 NI/Min.

Remark: All high pressure hoses have a port on the pump side AG 3/8" NPT as well as a Cejn quick coupling for connecting our crimping- and cutting heads at the other side. On request the pump is also available with larger oil tanks as 5,0 l.

Hydraulic compression heads 60 kN up to 450 kN suitable for connection to our 700 bar basic pumps



Part-No. 12836
60 kN / 6-300 mm²
with foldable crimping head



Part-No. 12485
130 kN / 10-300 mm²
lateral insertion up to 25 mm Ø



Part-No. 12486
130 kN / 10-300 mm²
lateral insertion up to 38 mm Ø



Part-No. 12487
130 kN / 10-300 mm²



Part-No. 05256
250 kN / 10-630 mm²



Part-No. 12491
450 kN / 95-1000 mm²

Crimping dies for hydraulic actuated crimping heads 60 kN up to 450 kN

Part-No. 12836: System dies size II (half shell dies small design)
acc. to catalogue pages 204-205

Part-No. 05256: Crimping dies acc. to catalogue pages 208-209

Part-No. 12485-87: System dies size III (half shell dies large design)
acc. to catalogue pages 206-207

Part-No. 12491: Crimping dies acc. to catalogue page 209

Hydraulic compression unit 130 kN

suitable for mounting on tables and connecting to our 700 bar basic pumps



- Universally applicable compact table top unit
- Suitable for working with a variety of different crimping dies, resulting in an extensive range of applications
- Lateral insertion and removal of cables and connectors up to 25 mm Ø
- Suitable for working with druseidt crimping dies size III (half shell dies, large design)
- The use of these system dies reduces the necessary number of crimp operations caused by the large crimping width
- With quick coupling connection for easy connection to our basic pumps

Part-No.	cross-section range	crimping force	description	weight kg/pcs.
12837	10-300 mm ²	130 kN	Small C-shaped table crimping unit	12,00

Remark: Suitable for working with druseidt crimping dies size III (half shell dies, large design). See pages no. 200-201. Lateral insertion up to Ø 25 mm Ø. With quick coupling connection.

Range of application/deliverable crimping dies

- **Indent-crimping 10-240 mm²**
for cable lugs acc. to DIN 46234 + DIN 46230
- **Indent-crimping 10-95 mm²**
for druseidt stainless steel cable lugs
- **WM-crimping 10-300 mm²**
for tubular cable lugs and connectors
- druseidt Standardseries
- druseidt Euroseries
- **WM-crimping 10-240 mm²**
for tubular cable lugs an connectors
- druseidt design for fine stranded cables
- **Hexagonal-crimping 10-300 mm²**
for cable lugs and connectors
- copper DIN 46235/DIN 46267 part 1
- aluminium DIN 46329/DIN 46267 part 2
- **Round-crimping dies 25/35-240/300 mm²**
- **Trapezoid crimping 25-185 mm²**
for cable end sleeves acc. to DIN 46228 part 1 + 4
- **Crimping dies for C- and H-shaped connectors 70-120 mm² on request**

Selection charts for crimping dies with Part-No. and description are listed in this catalogue on pages 206-207.

Hydraulic cable cutting heads

for copper- and aluminium- resp. ACSR cables
suitable for connection to our 700 bar basic-pumps



12832



12833

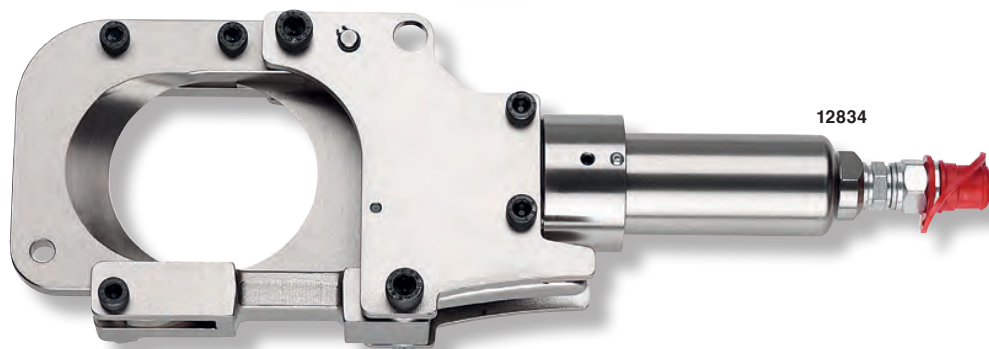

12834



12835

Part-No.	max. cutting-Ø	cutting force	suitable for	length	weight kg/pcs.
12832	45 mm	60 kN	ACSR-Kabel	320 mm	3,5
12833	50 mm	60 kN	Cu-/Al-Kabel	320 mm	2,7
12834	85 mm	70 kN	Cu-/Al-Kabel	420 mm	5,2
12835	95 mm	130 kN	Cu-/Al-Kabel	420 mm	9,8

Remark: All cutting heads will be delivered with quick couplings. Part-No. 12832 is suitable for cutting ACSR-cables up to an outer-Ø of 45 mm. All other cutting heads are designed for cutting copper- and aluminium cables in the described diameter range. They are not applicable for cutting steel wires, cables with steel-inserts or solid conductors. They are also not applicable for all kinds of live line working.

System dies size I (flat design)

suitable for hand operated hydraulic compression tools Part-No. 12930/12933 acc. to catalogue page 171 as well as battery operated hydraulic compression tools Part-No. 14240/42 acc. to page 176, 12748 acc. to page 178 and Part-No. 12728 acc. to page 188.



Indent-crimping 10-70 mm²

for cable lugs acc. to DIN 46234 + 46230

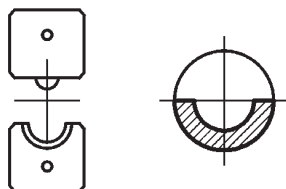

Part-No.	cross-section mm ²	information
12150	10	Suitable tools for all cross-section ranges 12930/12933, 14240/42, 12748 and 12728.
12151	16	
12152	25	
12153	35	
12154	50	
12155	70	

Indent-crimping 1,5-35 mm²

for druseidt stainless steel cable lugs

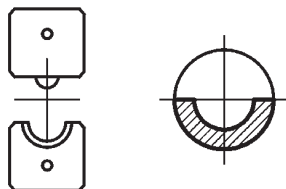

Part-No.	cross-section mm ²	information
12503	1,5 - 2,5	All crimping dies can be installed in our tools 12930/12933, 14240/42, 12748 and 12728. Up to a cross-section range of 35 mm ² it is necessary to work for copper and stainless steel cables with different crimping dies.
12504	4-6	
12505	10	
12506	16	
12507	25	
12508/VA	35	
12508/CU	35	

WM-crimping 10-300 mm²

for tubular cable lugs and connectors druseidt standard design, crimping width 5 mm

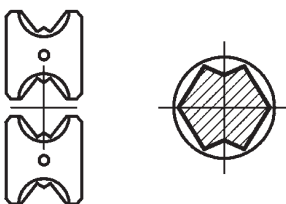

Part-No.	cross-section mm ²	information
12923	10 + 120	Suitable tools for cross-section up to 240 mm ² 12930/12933 and 12728 and for cross-section up to 300 mm ² 14240/42 and 12748.
12924	16 + 70	
12925	25 + 95	
12926	35 + 50	
12927	150	
12928	185	
12929	240	
12929/300	300	

WM-crimping 10-300 mm²

for tubular cable lugs and connectors druseidt Euro-type design, crimping width 5 mm

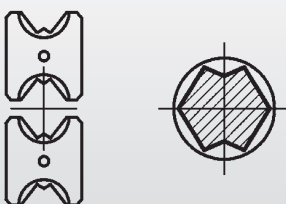

Part-No.	cross-section mm ²	information
12400	10 + 120	Suitable tools for cross-section up to 240 mm ² 12930/12933 and 12728 and for cross-section up to 300 mm ² 14240/42 and 12748
12401	16 + 70	
12402	25 + 95	
12403	35 + 50	
12927	150	
12928	185	
12929	240	
12929/300	300	

System dies size I (flat design)

WM-crimping 10f-240f mm²

for tubular cable lugs and connectors
druseidt design for fine stranded cables, crimping width 5 mm

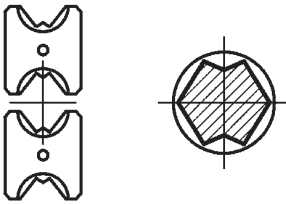

Part-No.	cross-section mm ²	information
12492	10f + 25f	Suitable tools for cross-section up to 185f mm ² 12930/12933 and 12728 and for cross-section up to 240f mm ² 14240/42 and 12748
12493	16f + 35f	
12494	50f	
12495	70f	
12496	95f	
12497	120f	
12498	150f	
12499	185f	
12499/240f	240f	

Hexagonal-crimping 10-300 mm²

for copper cable lugs and connectors
acc. to DIN 46235/46267 part 1, crimping width 5 mm

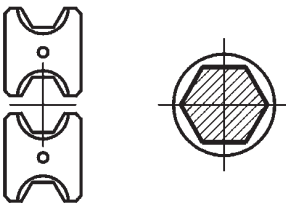

Part-No.	cross-section mm ²	code-no.	information
12945	10 + 120	6 + 20	Suitable tools for cross-section up to 185 mm ² 12930/12933 and 12728 and for cross-section up to 300 mm ² 14240/42 and 12748
12946	16 + 70	8 + 16	
12947	25 + 95	10 + 18	
12948	35 + 50	12 + 14	
12949	150	22	
12950	185	25	
12951	240	28	
12952	300	32	

Hexagonal-crimping 16-300 mm²

for aluminium-cable lugs and connectors
acc. to DIN 46329/46267 part 2, crimping width 7 mm

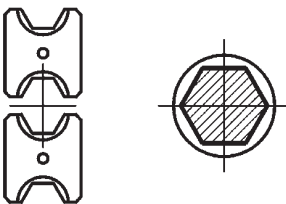

Part-No.	cross-section mm ²	code-no.	information
12324	16/25 + 35	12 Al + 14 Al	Suitable tools for cross-section up to 185 mm ² 12930/12933 and 12728 and for cross-section up to 300 mm ² 14240/42 and 12748
12325	16/25 + 50	12 Al + 16 Al	
12326	70	18 Al	
12327	95/120	22 Al	
12328	150	25 Al	
12329	185	28 Al	
12330	240	32 Al	
12331	300	34 Al	

Round-crimping dies 25/35-185/240 mm²

for sector shaped copper and aluminium conductors,
crimping width 12 mm

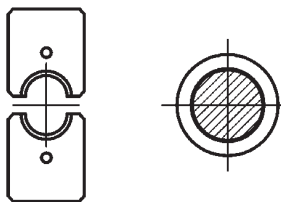

Part-No.	cross-section mm ²		information
	sm	se	
12955	25	35	Suitable tools for all cross-section ranges 12930, 12933, 14240/42, 12748 and 12728
12956	35	50	
12957	50	70	
12958	70	95	
12959	95	120	
12960	120	150	
12961	150	185	
12962	185	240	

Trapezoid crimping 10-95 mm²

for cable end sleeves acc. to DIN 46228 part 1 + 4,
crimping width 20 mm

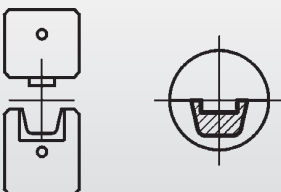

Best.-Nr.	Querschnitt mm ²	Hinweis
12111	10	Suitable tools for all cross-section ranges 12930/12933, 14240/42 and 12728.
12112	16	
12113	25	
12114	35	
12115	50	
12116	70	
12117	95	

System dies size II (half shell dies, small design)

suitable for hand operated crimping tool with telescoping handles Part No. 12869 acc. to catalogue page no. 162 and hydraulic compression tool Part-No. 12766 acc. to catalogue page 172, battery operated hydraulic tools 14240/41 acc. to catalogue page 176, Part No. 12724 acc. to catalogue page no. 191 resp. 13552 acc. to catalogue page 180 and hydraulic compression head Part No. 12836 acc. to catalogue page 199



Indent-crimping 10-120 mm²

for cable lugs acc. to DIN 46234 + 46230

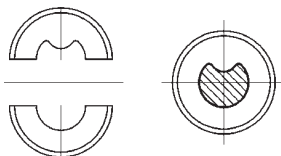

Part-No.	cross-section mm ²	information
12577	10	Suitable tools for all cross-section ranges 12766, 12869, 12724, 14240/41, 13552 and 12836.
12578	16	
12579	25	
12580	35	
12581	50	
12582	70	
12583	95	
12584	120	

Indent-crimping 1,5-35 mm²

for druseidt stainless steel cable lugs

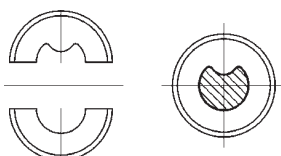

Part-No.	cross-section mm ²	information
12585	1,5 - 2,5	Suitable tools for all cross-section ranges 12766, 12869, 12724, 14240/41, 13552 and 12836. Up a cross-section range of 35 mm ² it is necessary to work for copper and stainless steel cables with different crimping dies.
12586	4 - 6	
12587	10	
12588	16	
12590	25	
12591/VA	35	
12591/CU	35	

WM-crimping 10-300 mm²

for tubular cable lugs and connectors
druseidt standard design, crimping width 5 mm

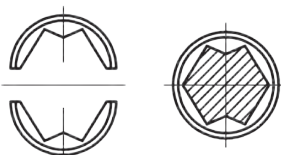

Part-No.	cross-section mm ²	information
13963	10	Suitable tools for all cross-section ranges 12766, 12869, 12724, 14240/41, 13552 and 12836.
13964	16	
13965	25	
13966	35	
13967	50	
13968	70	
13969	95	
13970	120	
13971	150	
13972	185	
13973	240	
13974	300	

WM-crimping 10-300 mm²

for tubular cable lugs and connectors
druseidt Euro-type design

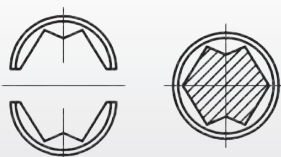

Part-No.	cross-section mm ²	information
13975	10	Suitable tools for all cross-section ranges 12766, 12869, 12724, 14240/41, 13552 and 12836.
13976	16	
13977	25	
13978	35	
13979	50	
13980	70	
13981	95	
13982	120	
13971	150	
13972	185	
13973	240	
13974	300	

System dies size II (half shell dies, small design)

WM-crimping 10f-240f mm²

for tubular cable lugs and connectors
druseidt design for fine stranded cables,
crimping width 5 mm

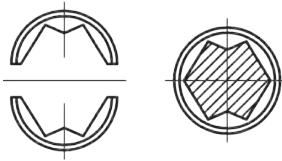

Hexagonal-crimping 6-240/300 mm²

for copper cable lugs and connectors acc. to DIN 46235/46267 part 1
and out of aluminium acc. to DIN 46329/46267, part 2,
crimping width 5 mm

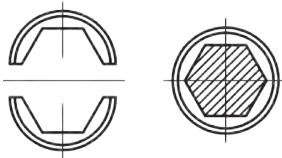

Round-crimping dies 25/35-185/240 mm²

for sector-shaped copper- and aluminium conductors,
crimping width 12 mm

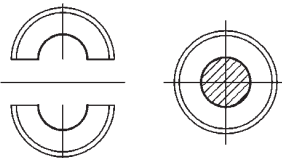

Trapezoid-crimping 10-240 mm²

for cable end sleeves acc. to DIN 46228 part 1 + 4,
crimping width 20 mm

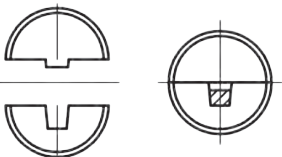

Trapezoid-crimping 2 x 4 up to 2 x 16 mm²

for Twin cable end sleeves,
crimping width 20 mm



Part-No.	cross-section mm ²	information
13485	10f	Suitable tools for all cross-section ranges 12766, 12869, 12724, 14240/41, 13553 and 12836.
13486	16f	
13487	25f	
13488	35f	
13489	50f	
13490	70f	
13491	95f	
13492	120f	
13493	150f	
13494	185f	
13495	240f	

Part-No.	cross-section mm ²		code-no.	information
	Cu	Al		
13987	6	-	5	Suitable tools for all cross-section ranges 12766, 12869, 12724, 14240/41, 13553 and 12836.
13988	10	-	6	
13989	16	-	8	
13990	25	-	10	
13991	35	16 + 25	12	
13992	50	35	14	
13993	70	50	16	
13994	95	70	18	
13995	120	-	20	
13996	150	95 + 120	22	
13997	185	150	25	
13998	240	185	28	
13999	300	240	32	

Part-No.	cross-section mm ²		information
	sm	se	
14140	25	35	Suitable tools for all cross-section ranges 12766, 12869, 12724, 14240/41, 13553 and 12836.
14141	35	50	
14142	50	70	
14143	70	95	
14144	95	120	
14145	120	150	
14146	150	185	
14147	185	240	

Part-No.	cross-section mm ²	information
13909	10	Suitable tools for all cross-section ranges 12766, 12869, 12724, 14240/41, 13553 and 12836.
13910	16	
13911	25	
13912	35	
13913	50	
13914	70	
13915	95	
13916	120	
13917	150	
13918	185	
13918	240	

Part-No.	cross-section mm ²	information
14148	2 x 4	Suitable tools for all cross-section ranges 12766, 12869, 12724, 14240/41, 13553 and 12836.
14149	2 x 6	
14150	2 x 10	
14151	2 x 16	

System dies size III (half shell dies, large design)

suitable for hand operated hydraulic compression tools Part-No. 12965/S and 12968 acc. to catalogue page 172, battery operated hydraulic compression tools 13551/25, 13551/42 and 13537 acc. to catalogue page 183 and hydraulic compression heads 12485 acc. to catalogue page 199 resp. tabletop unit 12837 acc. to catalogue page 200

Indent-crimping 10-240 mm²

for cable lugs acc. to DIN 46234 + 46230

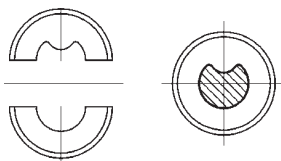

Part-No.	cross-section mm ²	information
14120	10	When ordering the dies 14120-30 it is necessary to order the suitable indenter too. Suitable tools for all cross-section ranges 12965/S, 12968, 13551/25, 13551/42, 13537, 12485, 12837
14121	16	
14122	25	
14123	35	
14124	50	
14125	70	
14126	95	
14127	120	
14128	150	
14129	185	
14130	240	
Indenter		
14131	10 - 35	
14132	50 - 95	
14133	120 - 240	

Indent-crimping 10-95 mm²

for druseidt stainless steel cable lugs

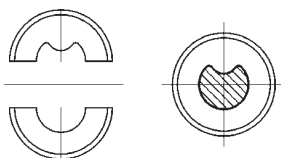

Part-No.	cross-section mm ²	information
14163	10	Suitable tools for all cross-section ranges 12965/S, 12968, 13551/25, 13551/42, 13537, 12485, 12837 The crimping dies 14166/VA-14169/VA are suitable for crimping stainless steel cables and the dies 14166/Cu-14169/Cu for crimping copper cables with stainless steel lugs. When crimping cross-sections up to 25 mm ² copper- and stainless steel cables can be crimped with the same die-set.
14164	16	
14165	25	
14166/VA	35	
14166/CU	35	
14167/VA	50	
14167/CU	50	
14168/VA	70	
14168/CU	70	
14169/VA	95	
14169/CU	95	

WM-crimping 10-300 mm²

for tubular cable lugs and connectors druseidt standard design

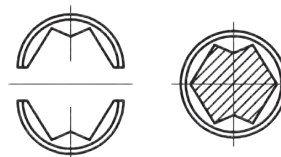

Part-No.	cross-section mm ²	crimping width	information
13048	10	7	Suitable tools for all cross-section ranges 12965/S, 12968, 13551/25, 13551/42, 13537, 12485, 12837
13049	16	7	
13050	25	10	
13051	35	12	
13052	50	14	
13053	70	14	
13054	95	14	
13055	120	14	
13056	150	14	
13057	185	14	
13058	240	14	
13059	300	7	

WM-crimping 10-300 mm²

for tubular cable lugs and connectors druseidt Euro-design

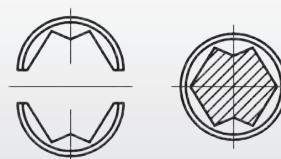

Part-No.	cross-section mm ²	crimping width	information
14170	10	7	Suitable tools for all cross-section ranges 12965/S, 12968, 13551/25, 13551/42, 13537, 12485, 12837
14171	16	7	
14172	25	12	
14173	35	12	
14174	50	14	
14175	70	14	
14176	95	14	
14177	120	14	
13056	150	14	
13057	185	14	
13058	240	14	
13059	300	7	

System dies size III (half shell dies, large design)

WM-crimping 10f-240f mm²

for tubular cable lugs and connectors
druseidt design for fine stranded cables

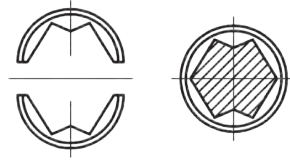

Part-No.	cross-section mm ²	crimping width	information
13540	10f	7	Suitable tools for all cross-section ranges 12965/S, 12968, 13551/25, 13551/42, 13537, 12485, 12837
13541	16f	10	
13542	25f	12	
13543	35f	14	
13544	50f	14	
13545	70f	14	
13546	95f	14	
13547	120f	14	
13548	150f	14	
13549	185f	14	
13550	240f	7	

Hexagonal-crimping 10-300 mm²

for copper cable lugs and connectors acc. to DIN 46235/46267 part 1
and aluminium acc. to DIN 46329/46267 part 2

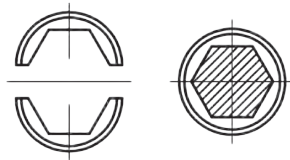

Part-No.	cross-section mm ²		code-no.	crimping width
	Cu	Al		
12980	10	-	6	7
12981	16	-	8	14
12982	25	-	10	14
12983	35	16/25	12	12
12984	50	35	14	12
12985	70	50	16	12
12986	95	70	18	12
12987	120	-	20	12
12988	150	95/120	22	14
12989	185	150	25	14
12990	240	185	28	14
12991	300	240	32	7
12992/300	-	300	34	7

Information: Suitable tools for all cross-section ranges 12965/S, 12968, 13551/25, 13551/42, 13537, 12485, 12837

Round-crimping dies 25/35-240/300 mm²

for sector shaped copper- and aluminium conductors,
crimping width 35 mm

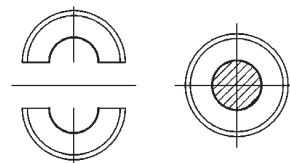

Part-No.	cross-section mm ²		information
	sm	se	
12992	25	35	Suitable tools for all cross-section ranges 12965/S, 12968, 13551/25, 13551/42, 13537, 12485, 12837
12993	35	50	
12994	50	70	
12995	70	95	
12996	95	120	
12997	120	150	
12998	150	185	
12999	185	240	
12907	240	300	

Trapezoid-crimping 25-185 mm²

for cable end sleeves DIN 46228 part 1 + 4



Part-No.	cross-section mm ²	crimping width	information
14152	25	20	Suitable tools for all cross-section ranges 12965/S, 12968, 13551/25, 13551/42, 13537, 12485, 12837
14153	35	20	
14154	50	26	
14155	70	26	
14156	95	26	
14157	120	26	
14158	150	26	
14159	185	26	

Exchangeable crimping dies for crimping head 05256 / 250 kN

WM-Crimping 10-630 mm²

for tubular cable lugs and connectors
druseidt standard design

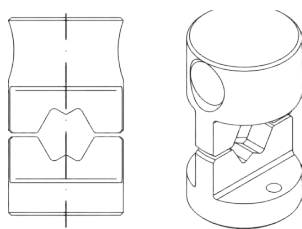

WM-Crimping

Part-No.	cross-section mm	crimping width mm
12135	10	7
12136	16	7
12137	25	10
12138	35	12
12139	50	14
12140	70	14
12141	95	14
12142	120	14
12143	150	14
12144	185	14
12145	240	14
12918/UL	300	14
12919/UL	400	14
12920/UL	500	14
12149	630	14

WM-Crimping 10-630 mm²

for tubular cable lugs and connectors
druseidt Euro-design

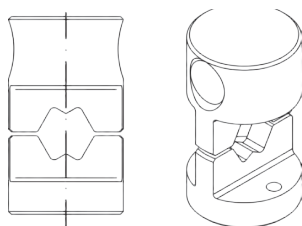

WM-Crimping

Part-No.	cross-section mm	crimping width mm
14178	10	7
14179	16	7
14180	25	12
14181	35	12
14182	50	14
14183	70	14
14184	95	14
14185	120	14
12143	150	14
12144	185	14
12145	240	14
12918/UL	300	14
12919/UL	400	14
12920/UL	500	14
12149	630	14

WM-Crimping 10-300 mm²

for tubular cable lugs and connectors
druseidt design for fine stranded cables

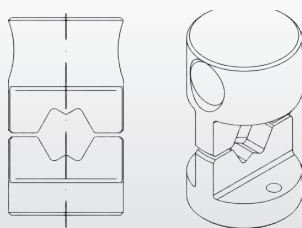

WM-Crimping

Part-No.	cross-section mm	crimping width mm
14250	10f	7
14251	16f	10
14252	25f	12
14253	35f	14
14254	50f	14
14255	70f	14
14256	95f	14
14257	120f	14
14258	150f	14
14259	185f	14
14260	240f	14
14261	300f	14

Exchangeable crimping dies for crimping head 05256 / 250 kN

Hexagonal crimping 10-630 mm²

for copper- and aluminium cable lugs and connectors
according to DIN 46235/46267 part 1, DIN 46329 / 46267 part 2

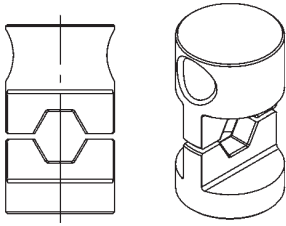

Hexagonal-crimping

Part-No.	cross-section mm ²		code-no.	crimping width mm
	Cu	Al		
12533	10	-	6	5
12908	16	-	8	14
12909	25	-	10	14
12910	35	16/25	12	12
12911	50	35	14	12
12912	70	50	16	12
12913	95	70	18	12
12914	120	-	20	12
12915	150	95/120	22	14
12916	185	150	25	14
12917	240	185	28	14
12918	300	240	32	12
12918/Al	-	300	34	17
12919	400	400	38	17
12920	500	-	42	17
12921	630	500	44	17

Round-crimping dies 25/35-300/400 mm²

for sector-shaped copper- and aluminium dies

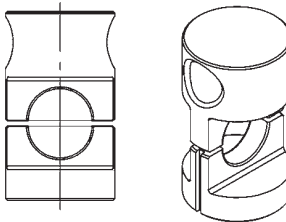

Round-crimping

Part-No.	cross-section mm ²		crimping width mm
	sm	se	
12520	25	35	40
12521	35	50	40
12522	50	70	40
12523	70	95	40
12524	95	120	40
12525	120	150	40
12526	150	185	40
12527	185	240	40
12528	240	300	40
12529	300	400	40

Exchangeable crimping dies for crimping head 12491 / 450 kN

Hexagonal crimping 95-1000 mm²

for copper- and aluminium cables and connectors
according to DIN 46235/46267 part 1, DIN 46329/46267 part 2

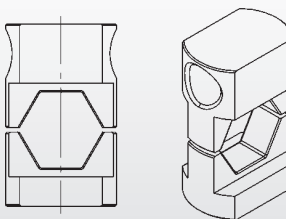

Hexagonal-crimping

Part-No.	cross-section mm ²		code-no.	crimping width mm
	Cu	Al		
12534	95	70	18	12
12535	120	-	20	14
12536	150	95/120	22	14
12538	185	150	25	14
12539	240	185	28	14
12540	300	240	32	17
12540/Al	-	300	34	17
12541	400	400	38	17
12542	500	-	42	17
12543	630	500	44	17
12544	800	630	52	25
12545	1000	800	58	25
12546	-	1000	60	25